

The Dubai Duty Free Grandstand Second Floor

CEILING HEIGHT MAX: 3.2m

TOTAL AREA: 870.30m²

LIFT DOORS

W- 1.16m, H- 2.10m

LIFT INTERNAL

W-1.94m, H-2.32m, D1.75m

LIFT CAPACITY

1600kg 21 people

MAIN ENTRANCE

W-1.40m, H-2.10m

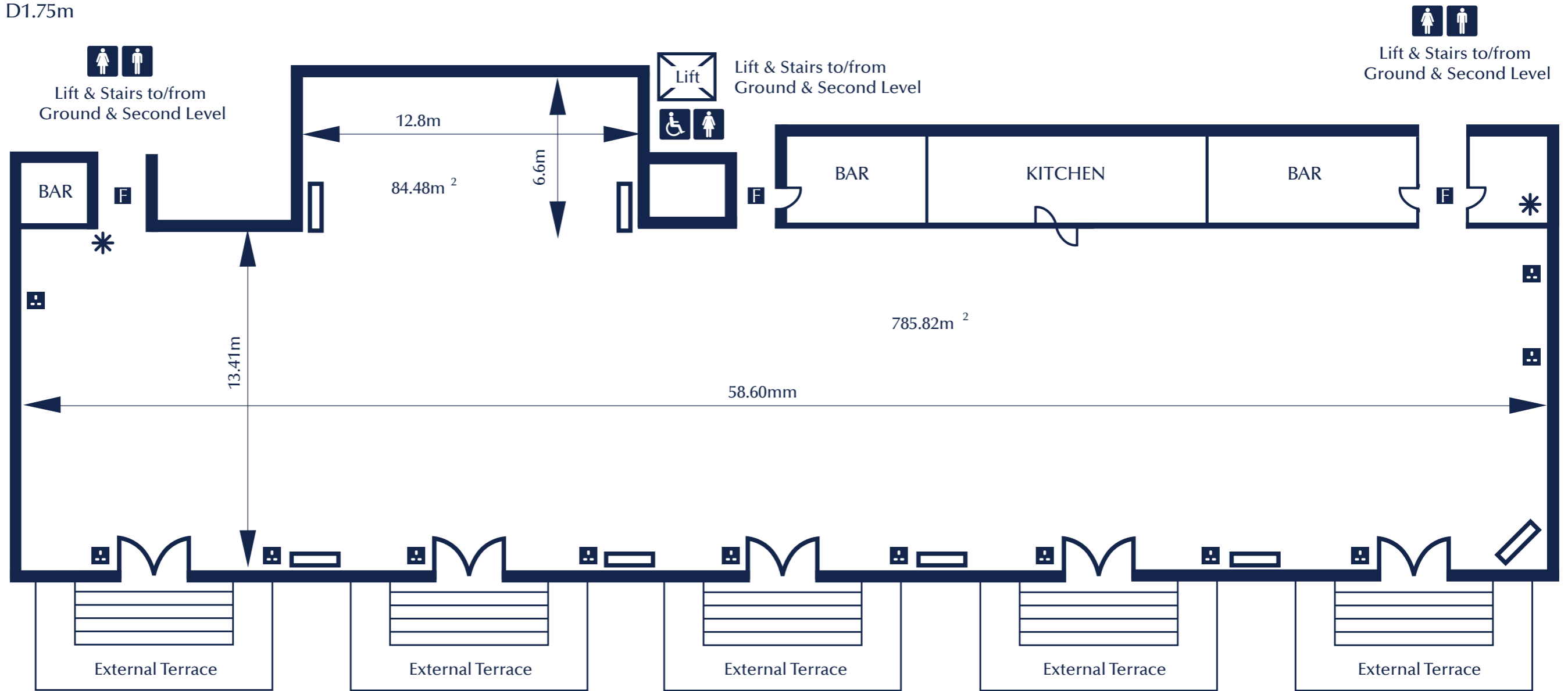

Lift & Stairs to/from Ground & Second Level

Lift & Stairs to/from Ground & Second Level

Lift & Stairs to/from Ground & Second Level

KEY

- Power Points
- Toilets
- 3 Phase Power 63 or 32 Amp
- VDU
- Fire Doors

RACECOURSE

