

etc.venues County Hall

Belvedere Road, London SE1 7PB

MEETINGS & EVENTS



etc.venues County Hall is located on London's Southbank overlooking the River Thames and offers 30 multi-use meeting rooms across 68,000 square-feet and two floors. Able to accommodate up to 400 guests, it is ideal for investor conferences, roadshows, stakeholder events, government summits, and team-building events.

Located in historic County Hall, the building has been expertly restored, keeping many of the original features while incorporating high-quality design elements for maximum comfort and productivity. The venue boasts breathtaking views of The Houses of Parliament, Big Ben, and the London Eye; offers exclusive use opportunities; and provides select branding and signage opportunities, in-house communal catering-of-the-day as well as private dining options, in-room plug-and-play technology, and shared hospitality resources.

etc.venues County Hall is easily accessible via public transportation.

30
MEETING ROOMS

400
MAX ROOM CAPACITY

68,000
SQUARE FEET



HIGH SPEED
WIFI



STATE OF THE ART
TECHNOLOGY



FLEXIBLE MEETING
& EVENT SPACE



EVENT PLANNING
SERVICES



ON-SITE
GOURMET CHEF



PREMIUM
DESIGN



This collateral is based on the latest information reasonably available and may be updated on a periodic basis. Please check with your Convene Account Manager for the latest information.

convene | etc.venues

CONVENE.COM | + 44 (0)80 0640 6630

Floorplan & Capacities

3RD FLOOR

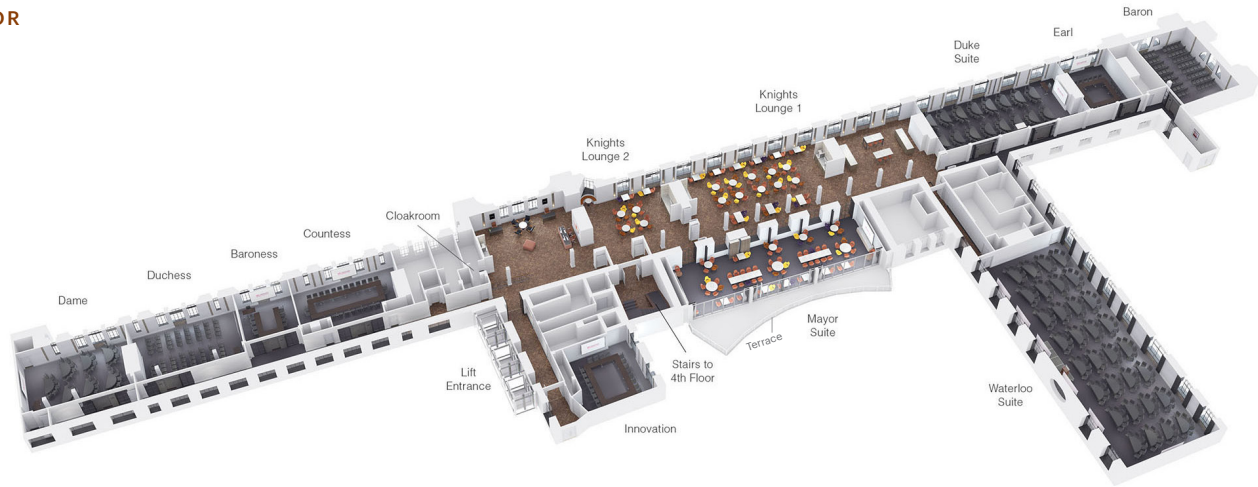

	AREA [ft²]	AREA [m²]	THEATRE	CRESCENT CABARET	CLASSROOM	BANQUET	BOARDROOM	U-SHAPE	EXHIBITION [STANDS]
Knights Lounge	2368 ft²	220 m²	-	-	-	-	-	-	12
Baron	850 ft²	79 m²	80	48	40	60	32	28	-
Earl	548 ft²	51 m²	50	24	18	40	20	18	-
Duke Suite	1496 ft²	139 m²	160	96	72	100	52	48	8
Duke 1	613 ft²	57 m²	50	24	24	40	20	16	4
Duke 2	882 ft²	82 m²	70	48	36	60	32	24	5
Waterloo Suite	3100 ft²	288 m²	328	192	136	240	-	-	27
Mayor Suite	1550 ft²	144 m²	152	108	84	120	60	56	12
Mayor 1	979 ft²	91 m²	96	72	56	80	40	36	-
Mayor 2	570 ft²	53 m²	48	30	24	40	20	16	-
Countess	753 ft²	70 m²	56	36	24	50	28	20	-
Baroness	365 ft²	34 m²	32	18	12	20	12	12	-
Duchess	818 ft²	76 m²	64	36	30	50	28	24	-
Dame	818 ft²	76 m²	64	32	30	50	28	26	-
Innovation	602 ft²	56 m²	60	24	24	40	24	20	-

Floorplan & Capacities

4TH FLOOR

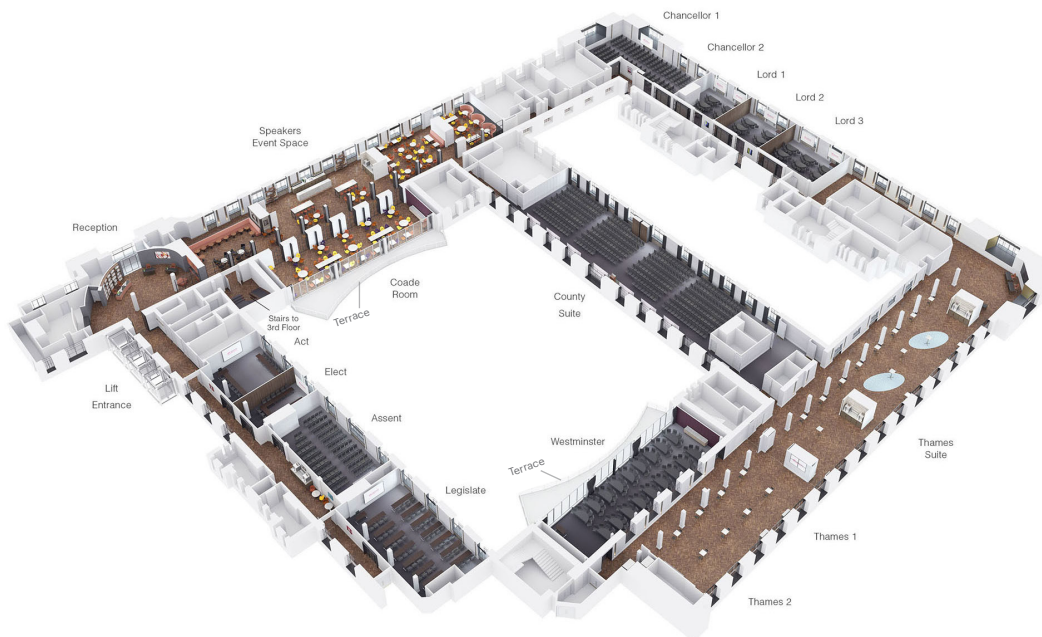

	AREA [ft ²]	AREA [m ²]	THEATRE	CRESCENT CABARET	CLASSROOM	BANQUET	BOARDROOM	U-SHAPE	EXHIBITION [STANDS]
Chancellor Suite	1625 ft ²	151 m ²	150	96	72	100	56	50	-
Chancellor 1	1001 ft ²	93 m ²	100	60	42	60	32	24	-
Chancellor 2	624 ft ²	58 m ²	50	36	24	40	24	20	-
Lord Suite	2077 ft ²	193 m ²	200	123	84	120	72	44	-
Lord 1 & 2	1280 ft ²	119 m ²	120	72	60	80	44	30	-
Lord 2 & 3	1474 ft ²	137 m ²	150	90	72	100	56	36	-
Lord 1	602 ft ²	56 m ²	40	36	24	30	20	18	-
Lord 2	678 ft ²	63 m ²	60	36	24	40	24	20	-
Lord 3	796 ft ²	74 m ²	70	54	36	60	28	22	-
Thames Suite (Includes Thames Lounge and Thames 1 & 2)	7297 ft ²	678 m ²	-	-	-	280	-	-	54
Thames Lounge	4779 ft ²	444 m ²	-	-	-	160	-	-	33
Thames 1 & 2	1797 ft ²	167 m ²	200	108	88	120	64	56	-

Floorplan & Capacities

4TH FLOOR

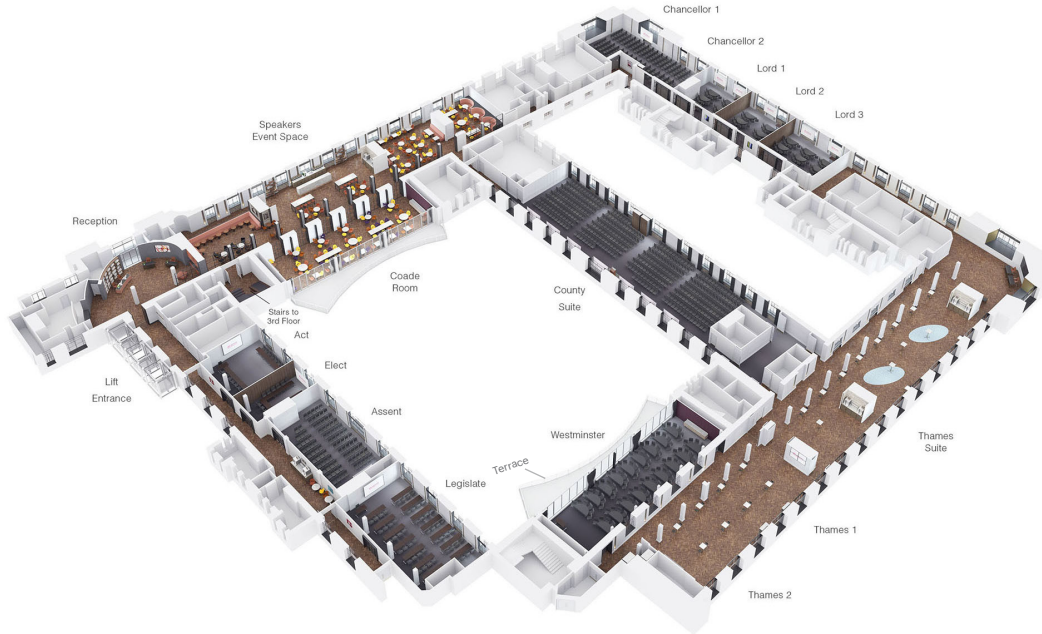

	AREA [ft ²]	AREA [m ²]	THEATRE	CRESCENT CABARET	CLASSROOM	BANQUET	BOARDROOM	U-SHAPE	EXHIBITION [STANDS]
Thames 1	893 ft ²	83 m ²	84	48	40	60	32	28	-
Thames 2	904 ft ²	84 m ²	84	48	40	60	32	28	-
Westminster	1539 ft ²	143 m ²	150	108	88	120	60	56	-
County Suite	4133 ft ²	384 m ²	400	252	180	260	-	-	36
County 1	2443 ft ²	227 m ²	224	140	96	150	-	-	20
County 2	1689 ft ²	157 m ²	160	96	72	120	-	-	13
The Coade Room	1539 ft ²	143 m ²	-	-	-	120	-	-	8
Act & Elect	1033 ft ²	96 m ²	100	60	40	60	40	34	-
Act	656 ft ²	61 m ²	60	30	24	40	28	22	-
Elect	376 ft ²	35 m ²	30	12	12	16	16	16	-
Assent	990 ft ²	92 m ²	100	48	44	70	40	36	-
Legislate	1237 ft ²	115 m ²	110	48	56	80	44	38	-