



<b>Year</b> <b>2023</b>	<b>Title</b> Events, parties and great times
<b>Location</b>	<b>411 St John Street, London EC1V 4AB</b>



# The 4.1.1

## Welcome to our Neighbourhood Bar

Step into a design-driven neighbourhood bar inspired by the timeless Manhattan lofts, featuring exposed brickwork, bare concrete finishes, oversized artworks, and statement furniture; a place where the creative energy of New York City's Soho district is alive and thriving. Floor-to-ceiling windows flood the space with natural light, creating a warm and inviting atmosphere for you to work, play, eat, and drink.

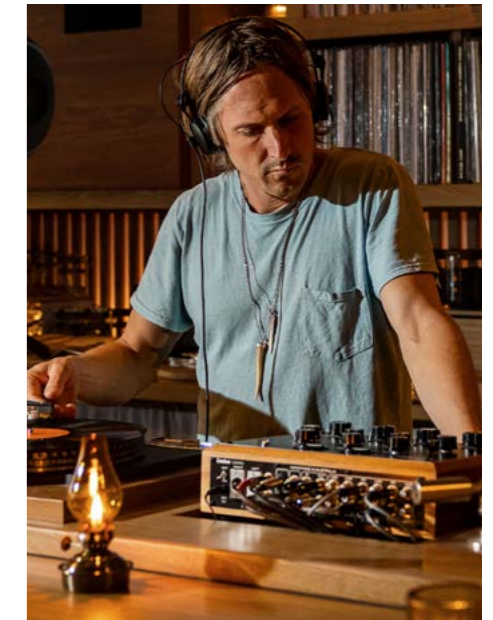

Images for Illustrative purposes only



# Capacity 500

STANDING OR SEATED



Disabled Access



Smoking Area



Wi-Fi



7 Large screens/  
Projectors



Late License Available

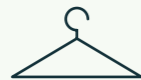

Cloakroom



In-house Sound System



DJ Equipment Specification

Pioneer XDJ-RX 2  
1 x Microphone

# THE SPACE

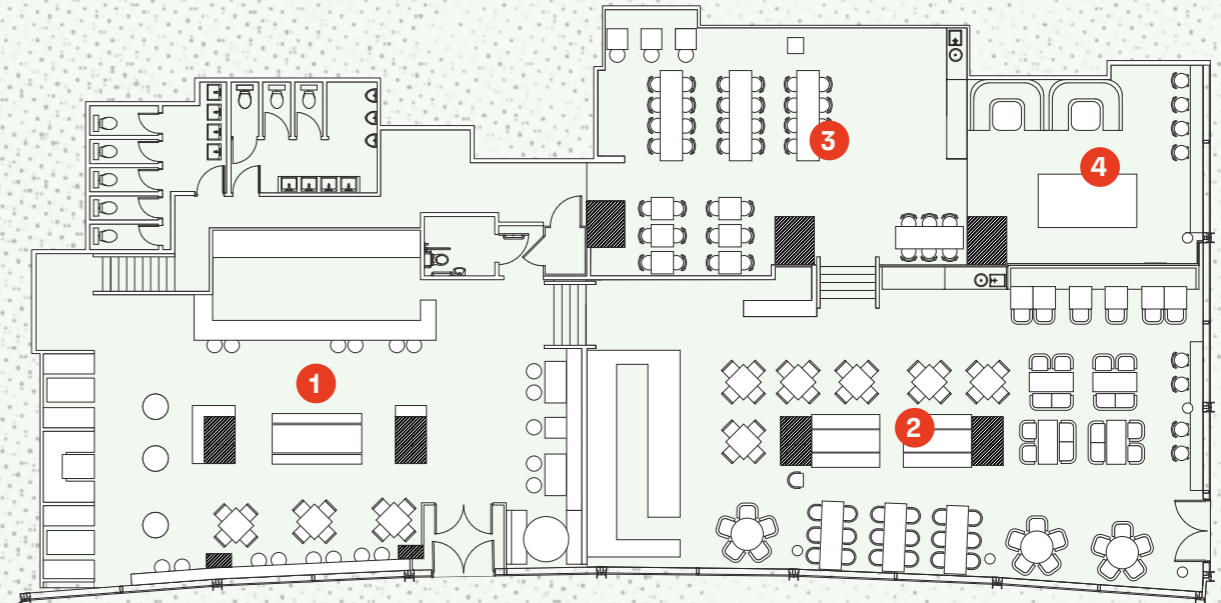

## Capacity

- 1 Main Bar** 200-250
- 2 The Lounge** 150-200
- 3 Dining Area** 80
- 4 The Pool Room** 40



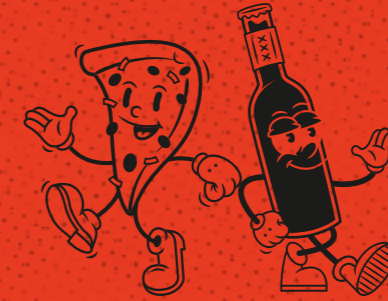

## Food & Drink

The 4·1·1's menu draws inspiration from the best of NYC's casual restaurant scene, serving quality comfort food in a relaxed setting. The drinks menu includes cocktails prepared using American bourbons and whiskies, craft beers, and thoughtfully chosen wines.



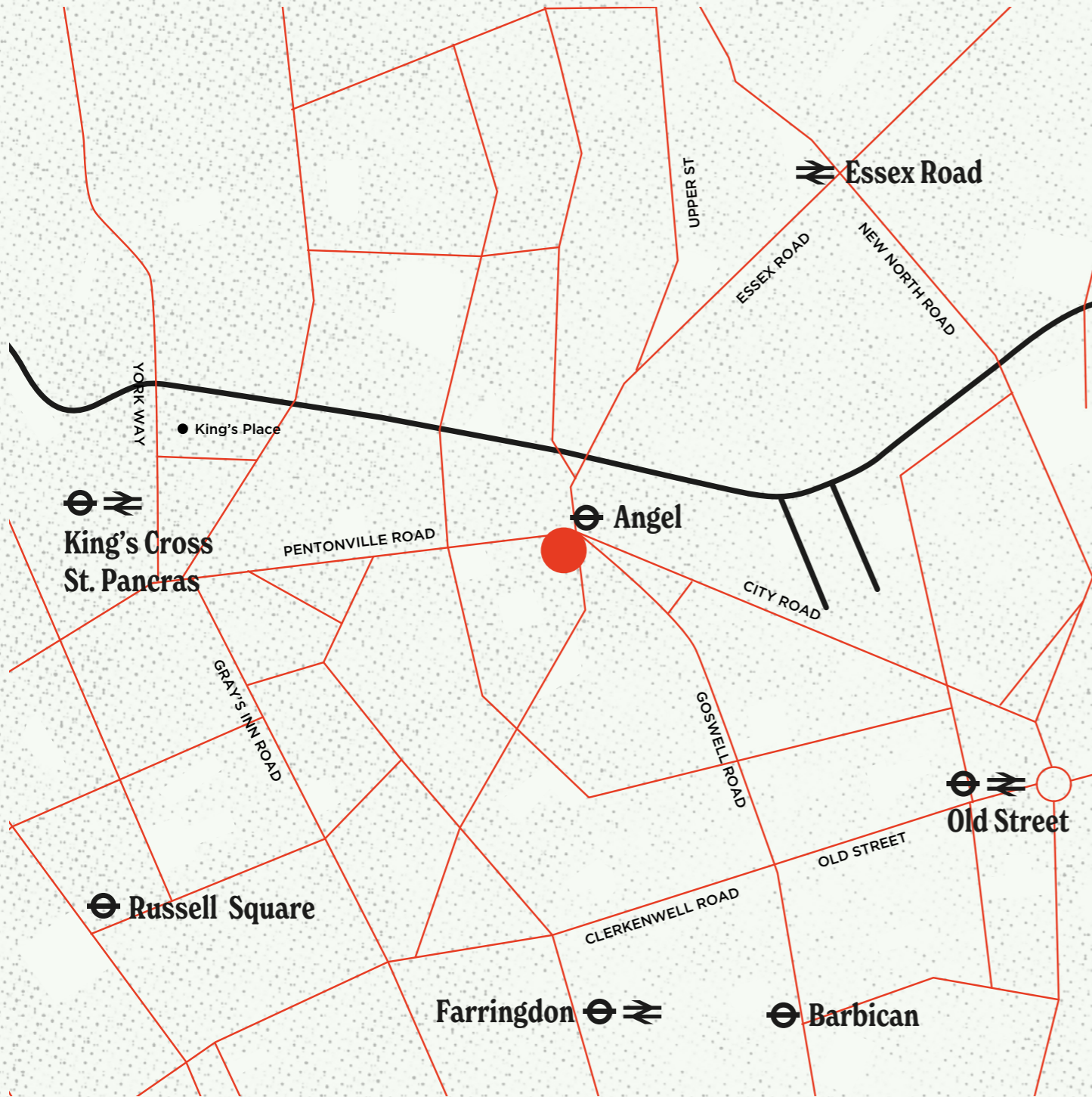

## Getting Here

We're just a short walk from Angel Station  
location in The Angel Building

**411 St John Street, London EC1V 4AB**

Angel Station .....	2 minute walk
Essex Road Station .....	15 minute walk (8 minute taxi)
Highbury & Islington Station .....	20 minute walk (10 minute taxi)
Old Street Station .....	20 minute walk (10 minute taxi)



Email [events@incipio-group.co.uk](mailto:events@incipio-group.co.uk)

Phone 020 4513 2499

411 St John Street, London EC1V 4AB

