

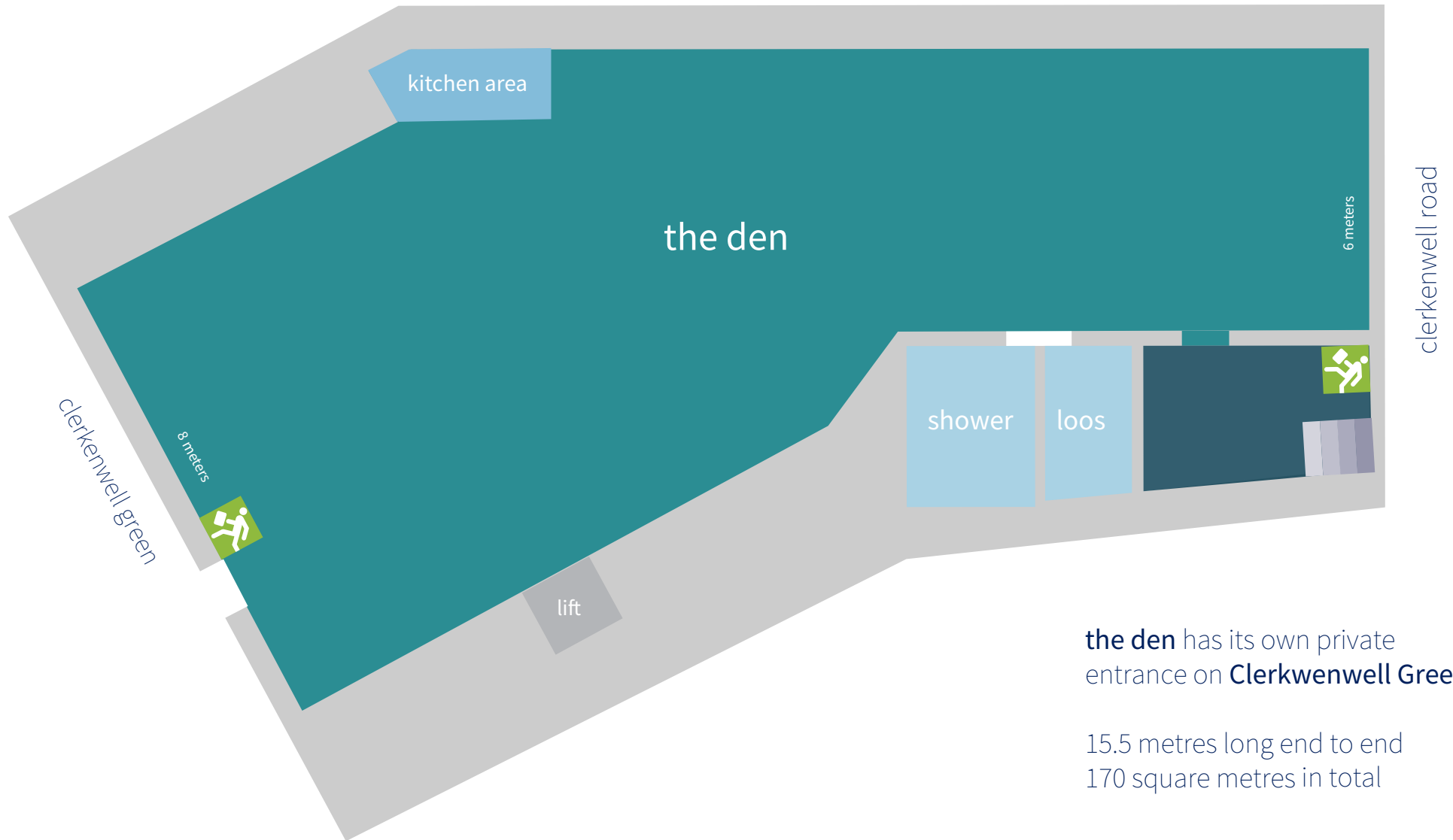

wallacespace clerkenwell green dimensions and capacities

	dimensions	minimum numbers	max. theatre style	max. u-shape tables + chairs	max. boardroom	max. u-shape chairs	max. cabaret	max. soft seating	working space in square metres
11 salt room	5.0 x 7.5 mtr	14	35	14	16	18	24	14	32
12 pepper room	5.0 x 7.5 mtr	12	30	14	16	18	20	14	32
salt + pepper	10 x 7.5 mtr	28	70	22	28	26	56	24	63.5
13 sugar room	4.4 x 2.5 mtr	6	15	8	10	10	0	8	14
14 ginger room	11 x 5.5 mtr	25	60	20	25	26	35	20	34.5
21 tea room	5.0 x 7.5mtr	14	35	14	16	18	24	14	32
22 coffee room	5.0 x 7.5 mtr	12	30	14	16	18	20	14	32
tea + coffee	10 x 7.5 mtr	28	70	22	28	26	56	24	63.5
13 copper room	4.4 x 2.5 mtr	6	15	8	12	10	0	10	17
14 tin room	5.4 x 3.3 mtr	14	26	14	18	24	24	18	34.5
31 silk room	5.1 x 7.5mtr	14	40	14	18	18	24	14	32
32 cotton room	5.1 x 7.5 mtr	12	35	14	18	18	20	14	32
silk + cotton	10.1 x 7.5 mtr	30	80	22	28	26	56	24	63.5
33 flax room	4.5 x 2.5 mtr	4	10	6	8	10	0	8	15
34 jute room	5.5 x 3.3 mtr	6	15	8	10	14	0	8	17
35 hemp room	5.5 x 3.3 mtr	6	15	10	10	14	0	8	17
penthouse a	10.0 x 7.0 mtr	35	75	25	n/a	30	40	26	65
penthouse b	12.5 x 4.0 mtr	25	60	22	26	26	45	24	48
the den	22 x 6 x 2.4 mtr	50	160	40	40	60	90	50	185
the kitchen	total m ² = 143 m ²	maximum numbers for dining 100 maximum numbers for a stand up reception 150 maximum numbers for a theatre style 150							



the den has its own private entrance on **Clerkwenwell Green**.

15.5 metres long end to end
170 square metres in total

