



INTERCONTINENTAL®
LONDON PARK LANE

WELCOME TO
NO. 1 PARK LANE



OUR HISTORY



InterContinental London Park Lane stands proudly today on the very site of 145 Piccadilly, Queen Elizabeth II's former childhood residence.

Situated at one of the capital's most prestigious addresses, InterContinental London Park Lane presents modern luxury in the heart of Mayfair.

Inspired by its location overlooking the Royal Parks, the hotel delivers elegant natural interiors and award-winning seasonal cuisine.

LOCATION AND INFORMATION

The hotel is easily accessible to several international airports.

Heathrow Airport is located 45 minutes by car, 55 minutes via the Piccadilly line underground or 30 minutes by Heathrow Express train.

Gatwick Airport is located 90 minutes by car or 45 minutes by train.

About the Hotel:

- 449 rooms
- 15 versatile event spaces (exclusive meeting and events floor with daylight and separate entrance)
- award-winning dining at Alex Webb on Park Lane and Theo Randall at the InterContinental
- Spa InterContinental
- IHG Business Rewards
- Responsible business: Journey to Tomorrow

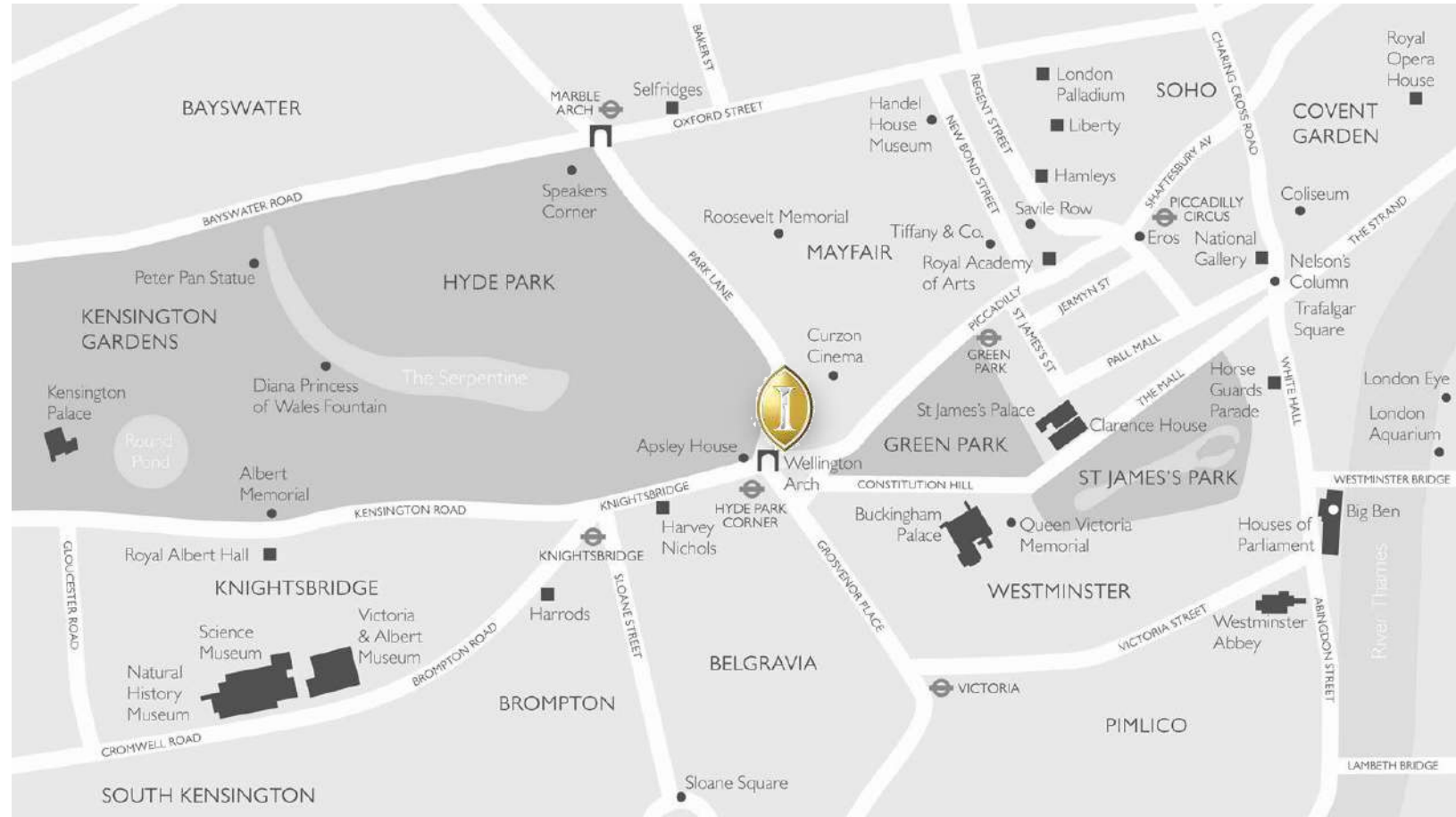

InterContinental London Park Lane

website: parklane.intercontinental.com

MEETINGS & EVENTS

PARK LANE SUITES & BALLROOM



From birthday celebrations to sumptuous balls, our purpose-built Mezzanine floor caters to all, each space allowing for multiple layout options.

Our events team and trusted partners will work closely with you to curate your bespoke event with innovation and creativity.

Event spaces can be themed and transformed with endless possibilities: customised decorations, visual effects and entertainment.

If the occasion calls for grandeur, a banquet in our lavish Ballroom can seat 750 people or host 1000 for a drink's reception.

FLOOR PLAN

For images of our event space, please visit our virtual walkthrough link → [InterContinental London Park Lane Mezzanine Floor](#)

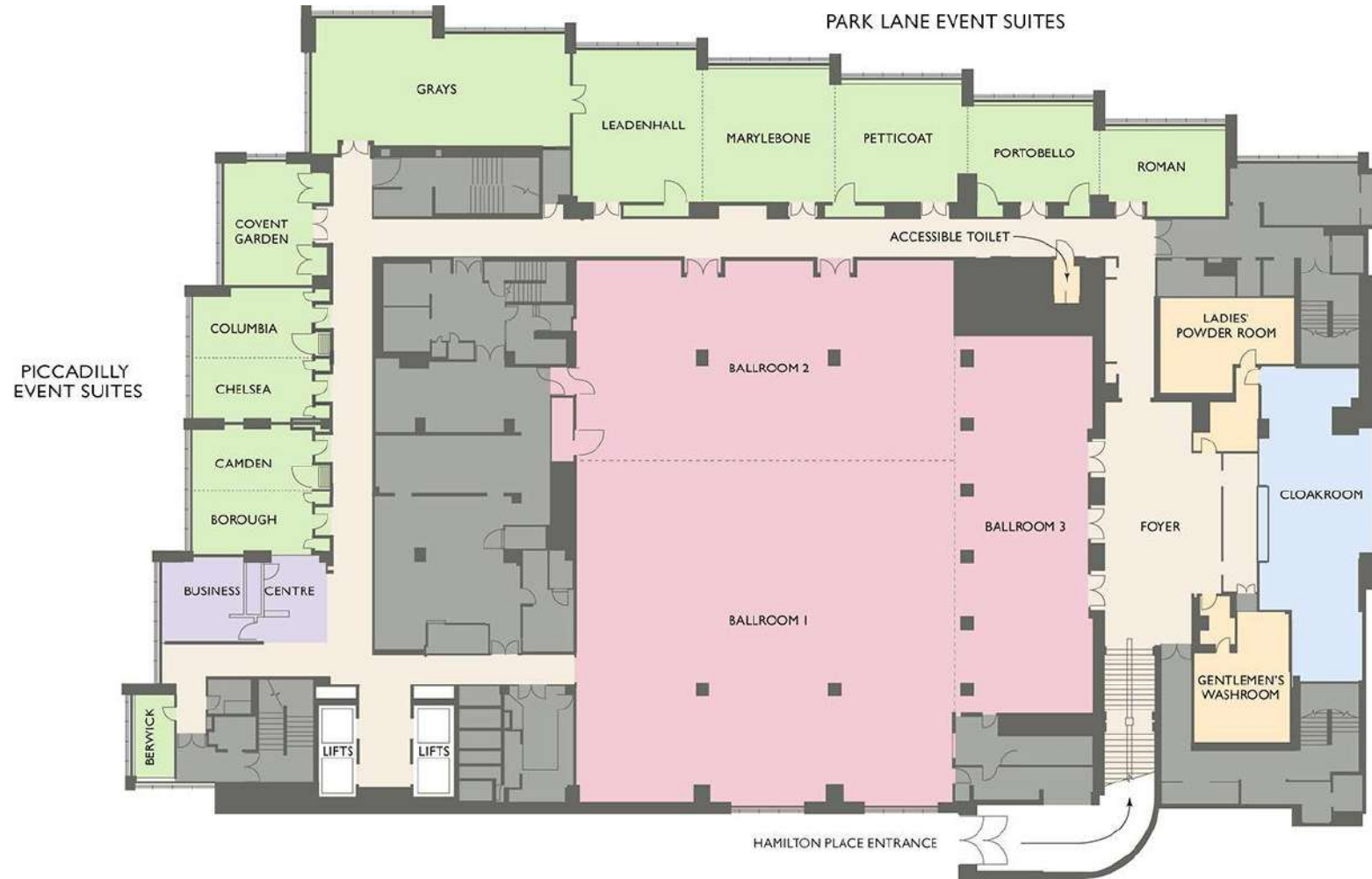

CAPACITY



ROOM	DIMENSIONS	AREA	THEATRE	CLASS-ROOM	BOARD-ROOM	CABARET	BANQUET	COCKTAIL RECEPTION
Ballroom [†]	30.3x29.3x4.1 m / 99.4x96.1x13.5 ft	841 m ² / 9052 ft ²	700	-	-	259	750	1000
Ballroom 1+2	31.2x21.7x4.1 m / 102.4x71.2x13.5 ft	676 m ² / 7291 ft ²	500	252	-	231	616	800
Ballroom 1	21.7x20.2x4.1 m / 71.2x66.3x13.5 ft	438 m ² / 4713 ft ²	300	135	-	126	336	400
Ballroom 2	21.7x11.0x4.1 m / 71.2x36.0x13.5 ft	238 m ² / 2563 ft ²	100	75	40	42	188	250
Ballroom 3	7.6x21.7x2.9 m / 25.0x71.2x9.5 ft	165 m ² / 1780 ft ²	150	54	40	42	120	200
PARK LANE EVENT SUITES								
1. Roman	7.2x4.8x2.6 m / 23.6x15.7x8.5 ft	35 m ² / 370.5 ft ²	20	12	12	7	24	40
2. Portobello	7.6x5.5x2.6 m / 24.9x18.0x8.5 ft	42 m ² / 448 ft ²	32	15	12	14	36	60
3. Petticoat	7.6x6.7x2.6 m / 24.9x21.9x8.5 ft	51 m ² / 545 ft ²	38	18	16	14	36	80
4. Marylebone	7.7x7.7x2.6 m / 25.2x25.2x8.5 ft	59 m ² / 635 ft ²	50	24	16	21	48	90
5. Leadenhall	7.4x8.6x2.6 m / 24.3x28.2x8.5 ft	64 m ² / 685 ft ²	52	30	18	21	60	110
6. Grays	14.7x6.4x2.7 m / 48.2x20.9x8.8 ft	94 m ² / 1007 ft ²	80	50	34	42	72	130
Park Lane Suites 1-6 **	52.2x6.6x2.6 m / 171.1x21.6x8.53 ft	345 m ² / 3695 ft ²	-	-	-	-	265	550
PICCADILLY EVENT SUITES								
7. Covent Garden	4.8x6.5x2.7 m / 15.7x21.3x8.8 ft	31 m ² / 334 ft ²	-	-	12	-	-	-
8. Columbia	6.5x3.8x2.7 m / 21.3x12.5x8.8 ft	25 m ² / 266 ft ²	15	-	10	7	12	12
9. Chelsea	6.5x3.5x2.7 m / 21.3x11.5x8.8 ft	23 m ² / 245 ft ²	15	-	10	7	12	12
Columbia & Chelsea 8+9	6.5x7.3x2.7 m / 21.3x24.0x8.8 ft	48 m ² / 511 ft ²	40	24	16	21	30	35
10. Camden	6.7x3.5x2.7 m / 22.0x11.5x8.8 ft	23.5 m ² / 253 ft ²	15	-	10	7	12	12
11. Borough	6.7x3.5x2.7 m / 22.0x11.5x8.8 ft	23.5 m ² / 253 ft ²	15	-	10	7	12	12
Camden & Borough 10+11	6.7x7.0x2.7 m / 22.0x23.0x8.8 ft	47 m ² / 506 ft ²	40	24	16	21	30	35
12. Berwick	2.2x4.6x2.7 m / 7.2x15.1x8.8 ft	10 m ² / 109 ft ²	-	-	4	-	-	-

WEDDINGS AT NO.1 PARK LANE

Say 'I do' in the heart of Mayfair at one of the capital's most prestigious addresses, InterContinental London Park Lane. Whether you are planning a flawless celebration for up to 600 guests in our ballroom or an intimate gathering with your nearest and dearest in one of our Park Lane Suites or private dining areas, our unique event spaces provide the perfect backdrop for your wedding day.



BEDROOMS & SUITES

Our **449** rooms and **71** expansive suites offer the ultimate luxury in accommodation in one of the most sought-after locations in London.



Rooms



Mayfair Floor



Suites

SPA INTERCONTINENTAL

Featuring state-of-the-art facilities and a collection of aromatherapy treatments designed to enhance your physical, mental, and emotional wellbeing, Spa InterContinental will leave you feeling de-stressed and rejuvenated.



THE DINING EXPERIENCE

THEO RANDALL AT THE INTERCONTINENTAL

London's diverse and evolving food scene presents some of the finest dining anywhere in the world and InterContinental London Park Lane is proud to house the capital's best Italian restaurant; Theo Randall at the InterContinental. Chef Theo Randall carefully blends the best local ingredients with hand-picked Italian imports to create rustic fare that continues to attract rave reviews.



Negroni Masterclass



Pasta Masterclass



Regional Tasting Menu



Chef's Table

THE DINING EXPERIENCE

ALEX WEBB ON PARK LANE

Expect to be taken on a gastronomic journey with an inventive and surprising menu characterised by clever and creative flavour combinations. Dishes are inspired by nostalgic flavours from Alex's childhood and his travels, while championing seasonal British produce for sea, land, and tree. You may choose from a two or three-course menu with a choice in dishes at each course, or a seven-course tasting menu.



AFTERNOON TEA AT THE WELLINGTON LOUNGE

Standing proudly on the former site of 145 Piccadilly - Queen Elizabeth II's former childhood home - the Wellington Lounge pays respect to its heritage by offering traditional afternoon tea with a modern twist for an experience fit for royalty.



THE ARCH BAR

With an elegant and refined interior, The Arch Bar provides a sophisticated location in the heart of Mayfair for pre or post dinner drinks, celebratory champagne or a discreet meeting. Delicious coffee or an eclectic cocktail combined with the views over Green Park make the unique space an enviable destination in the city.



IHG BUSINESS REWARDS

When you make bookings on behalf of others, for business or for pleasure, we're here to reward you. With IHG® Business Rewards, you can earn points every time you book accommodations, meetings, or events at nearly 6,000 participating IHG® Hotels & Resorts worldwide. Here's how

it works:

1

Join IHG Business Rewards and earn 3 points per \$1 USD.

2

Book corporate meetings and events like weddings for your group.

3

Take advantage of our promotions that can help you earn rewards faster.

[JOIN IHG BUSINESS REWARDS](#)

JOURNEY TO TOMORROW



Guided by IHG's purpose to provide True Hospitality for Good, InterContinental London Park Lane work to help shape the future of responsible travel in London - supporting our people and making a positive difference to our local communities, while preserving our planet's beauty and diversity long into the future.

see IHG 10-year responsible business plan [Journey to Tomorrow](#)



INTERCONTINENTAL®
LONDON PARK LANE

Thank you