



EDWARDIAN  
HOTELS  
LONDON

# Meetings and Events



## Contents

Meet with Edwardian	4
Unique Spaces	6
Food for Thought	8
Edward for Meetings	10
Private Dining	12
The Londoner	14
The May Fair, A Radisson Collection Hotel	26
The Edwardian Manchester, A Radisson Collection Hotel	32
Radisson Blu Edwardian, Heathrow Hotel and Conference Centre	38
Radisson Blu Edwardian, Hampshire	44
Radisson Blu Edwardian, Mercer Street	48
Radisson Blu Edwardian, Bloomsbury Street	52
Radisson Blu Edwardian, Grafton	56
Radisson Blu Edwardian, Kenilworth	60
Radisson Blu Edwardian, Vanderbilt	64
Radisson Blu Edwardian, Sussex	68
Radisson Blu Edwardian, New Providence Wharf	72
Edwardian Hotels London Directory	76
London Locations Map	78
Heathrow Map	80
Manchester Map	81
Contact us	82

## Meet with Edwardian

Discover a wide choice of stylish four and five-star hotels, each individual by design but all benefiting from our unique concepts in the best locations in London, Heathrow and Manchester.

Our professional meetings experts have years of experience hosting every kind of event imaginable, combining world-class facilities and amenities, innovative gastronomy and reliable connectivity with great service, total satisfaction and environmental sustainability.

Image: The Londoner





## Unique Spaces

From expansive glass atriums for large social gatherings to an intimate creative space, the perfect brainstorming hub, or an 8th floor penthouse with panoramic views of London's skyline; whatever your needs, we have an array of options to provide the perfect setting for any occasion.

Images: Mercer Street Lounge, The Londoner Drawing Room & Meeting Rooms breakout space (left clockwise), At the Hampshire Penthouse (below)



## Food for Thought

Our team are here to ensure you stay energised, motivated and focused, with a range of delicious menus to choose from. We promise to go above and beyond to bring you the very best in innovative and responsible gastronomy.

Specifically designed to improve efficiency and your ability to concentrate, we have a fantastic range of simple, wholesome and tasty offerings. Menus can be tailored to your tastes, and our dedicated and discreet expert teams can set the scene to match the mood.



## Edward for Meetings

Meet Edward: Your Dedicated Conference Host

Edward is an innovative and unique virtual assistant, developed specifically to match the needs of the hospitality industry. Text him to make requests and ask questions quickly and effortlessly.

Edward is available to all residential guests and event organisers at the hotel.

## High-speed complimentary Wi-Fi

Checking email, researching an idea that popped up during a break-out session, downloading a file or just catching up on the news during a coffee break – fast, reliable and complimentary Wi-Fi in all our hotels makes it all possible. Enjoy download speeds of up to 150Mbps on unlimited devices throughout the hotel.

## Rewards

Collect points for every meeting or event you book with our global rewards programmes. You could earn reward for complimentary nights, flights and special member-only rates and benefits.



Image: The Atrium at Heathrow

## Private Dining

Intimate, secluded, and unique, our Private Dining spaces in London and Manchester set the tone for an inspiring and exquisite dining experience. Led by a culinary team behind several award-winning restaurants, our delicious menus raise the standard for private events featuring seasonal and locally sourced ingredients.

A dedicated and experienced events team will help you at every turn to exceed your expectations, whether it be a corporate dinner, anniversary celebration or wedding breakfast.



Image: The Crystal Room at The May Fair

# The Londoner

Leicester Square ★★★★★

Set on London's legendary Leicester Square, The Londoner presents the world's first super boutique hotel.

The super boutique experience is individual and intimate, whilst encompassing unexpected capacities and dimensions. It matches the logistical and technological ability of the most dedicated meetings and events venues in the world.

From weddings to private dinners; big events, launch events and work events, board meetings and conferences and everything in between – experience the far reaches of possibility in the heart of the West End.

📶 Complimentary Wi-Fi up to 150Mbps on unlimited devices

🗣️ Edward virtual host

🏋️ 24-hour fully-equipped gym

🏆 I Prefer - Loyalty Programme

## THE LONDONER

38 Leicester Square  
London  
WC2H 7DX

T +44(0)20 7451 0101

E [events@thelondoner.com](mailto:events@thelondoner.com)

W [thelondoner.com](http://thelondoner.com)

📍 Leicester Square





# The Londoner

Leicester Square ★★★★★

## The Ballroom and Pre-Function Area

Launch parties. Inspiring conferences. Extravagant gala nights. Designed with big events in mind, The Ballroom offers rare opportunities and state-of-the-art audio-visual technology.

### Capacities

Suites	Theatre	Classroom	Boardroom	Cabaret	Lunch/Dinner	Reception
Ballroom	700	330	-	336	528	800
Ballroom A	328	160	48	144	216	370
Ballroom B	300	130	42	128	192	350
Ballroom Foyer	-	-	-	-	-	250

Suites	Area		Length		Width		Height	
	sq m	sq ft	m	ft	m	ft	m	ft
Ballroom	566	6,093	35.6	116' 8"	15.9	52' 2"	5.8	19'
Ballroom A	289	3,115	18.2	59' 7"	15.9	52' 2"	5.8	19'
Ballroom B	272	2,927	17.1	56' 1"	15.9	52' 2"	5.8	19'
Ballroom Foyer	237	2,551	-	-	-	-	2.3	7'5"



# The Londoner

Leicester Square ★★★★★

## The Green Room

Step into the elegant world of The Green Room. A timeless, dreamlike soirée space for up to 150 guests, with rich velvet furniture, a striking mirrored ceiling and contemporary design.

### Capacities

Suites	Standing guests	Area		Length		Width		Height	
		sq m	sq ft	m	ft	m	ft	m	ft
The Green Room	180	299	3,214	23.7	77' 8"	12.6	41' 3"	2.2	7' 2"



# The Londoner

Leicester Square ★★★★★

## Capacities

Suites	Theatre	Classroom	Boardroom	U-shape	Cabaret	Lunch/ Dinner	Reception
The National Gallery	25	-	10	8	8	12	30
Somerset House	25	-	10	8	8	12	30
The National Gallery + Somerset House	53	12	-	-	16	24	65
The Royal Academy of Arts	60	20	24	20	24	36	60
Tate Britain	49	16	16	14	16	24	50
Hayward Gallery	35	12	16	14	16	24	50
Tate Britain + Hayward Gallery	70	22	24	-	40	60	110
Serpentine Gallery	-	-	16	12	12	16	-
Maddox Gallery	-	-	14	12	12	14	-

Dimensions	Area		Length		Width		Height	
	sq m	sq ft	m	ft	m	ft	m	ft
The National Gallery	20	215	6.2	20' 4"	3.2	10' 6"	3.5	11' 6"
Somerset House	20	215	6.4	21'	3.2	10' 6"	3.5	11' 6"
The National Gallery + Somerset House	40	431	12.6	41' 4"	3.2	10' 6"	3.5	11' 6"
The Royal Academy of Arts	54	581	9.9	32' 6"	5.8	19'	3.5	11' 6"
Tate Britain	34	366	7.9	25' 11"	4.2	13' 9"	3.5	11' 6"
Hayward Gallery	34	366	7.9	25' 11"	4.2	13' 9"	3.5	11' 6"
Tate Britain + Hayward Gallery	68	732	15.8	51' 10"	4.2	13' 9"	3.5	11' 6"
Serpentine Gallery	35	377	8.4	27' 7"	4.3	14' 1"	3.5	11' 6"
Maddox Gallery	39	420	8.9	29' 2"	4.6	15' 1"	3.5	11' 6"

Dimensions	Standing	Area		Length		Width		Height	
		sq m	sq ft	m	ft	m	ft	m	ft
Gallery Foyer	171	162	1,744	16.8	55'	12.4	40' 6"	3.5	11' 5"
Gallery	275	256	2,756	25.8	84' 5"	12.4	40' 6"	-	-



# The Londoner

Leicester Square ★★★★★

## The Gallery

Welcome to The Londoner's private art collection. An inspiring multi-functional foyer and exhibition space with seven adjoining private rooms for meetings and private dinners, designed in partnership with the capital's most iconic art institutions.



# The Londoner

Leicester Square ★★★★★

## Bedrooms

### 350 Bedrooms & Suites

- 10 Queen Rooms
- 56 King Rooms
- 137 Deluxe King Rooms
- 110 Deluxe King City View Rooms
- 8 Junior Suites
- 20 Corner Suites
- 5 Capital Suites
- 2 Signature Suites
- The Tower Penthouse Suite

## Meeting & Events Areas

- The Ballroom
- The Green Room
- The Gallery's 7 meeting rooms
- 33 Syndicate rooms
- Two Screening Rooms

## Restaurants & Bars

- Whitcomb's
- The Stage
- 8 at The Londoner
- The Residence, featuring The Drawing Room, The Y Bar and The Whisky Room
- Joshua's Tavern

## Spa & Gym

- Swimming pool
- Sauna & Steam
- Fully equipped gym
- Cabanas & treatment rooms
- Refuel superfood clinic
- Hair & nail salon
- Barbershop

## Travel

### Car Park

- Whitcomb Street

### Underground

- Leicester Square (Piccadilly and Northern Lines)
- Piccadilly Circus (Bakerloo and Piccadilly Lines)
- Tottenham Court Road (Elizabeth Line)

### Trains

- Waterloo (1 mile)
- King's Cross St. Pancras Eurostar (2 miles)
- Charing Cross (7 mins walk)

### Airport

- City Airport (10 miles)
- Heathrow (18 miles)
- Gatwick (28 miles)
- Luton (35 miles)
- Stansted (37 miles)



# The May Fair, A Radisson Collection Hotel

May Fair ★★★★★

The May Fair is no ordinary meeting space. A glamorous heritage is captured in the retro chic of spectacular art deco furnishings. The Crystal Room is spacious enough to seat 280 theatre style and 260 for dinner. With state-of-the-art image projection and its own bar, experience sophistication beneath a glittering Baccarat chandelier.

One of the capital's largest private screening rooms, the 201-seat May Fair Theatre is also London's most impressive presentation space, with high-definition projection systems, THX quality spectacular sound, stage and stunning décor throughout. The theatre is the perfect space for film premieres, theatre, annual general meetings or product launches.

There are a further thirteen stylish private rooms, each unique in design and bathed in natural light, and each planned around an airy breakout area.

📶 Complimentary Wi-Fi up to 150Mbps on unlimited devices

👤 Edward virtual host

🏋️ 24-hour fully-equipped gym

🏆 Radisson Rewards

THE MAY FAIR HOTEL,  
A RADISSON COLLECTION HOTEL

Stratton Street  
London  
W1J 8LT

T +44(0)20 7915 3898

E [events@themayfairhotel.co.uk](mailto:events@themayfairhotel.co.uk)

W [themayfairhotel.co.uk](http://themayfairhotel.co.uk)

📍 Green Park



# The May Fair, A Radisson Collection Hotel

May Fair ★★★★★

## Capacities

Suites	Theatre	Classroom	Cabaret	U-Shape	Boardroom	Lunch/Dinner	Reception
Crystal	280	140	120	65	60	260	370
Theatre	201	201	-	-	-	-	-
Danziger	220	110	120	65	60	170	250
Atrium	-	-	-	-	-	-	150
Private Suite 1	50	30	24	22	20	50	60
Private Suite 2	-	-	-	16	18	18	-
Private Suite 3	40	20	24	22	20	40	50
Private Suite 4	-	-	-	-	10	10	-
Private Suite 5	30	18	18	18	16	30	40
Private Suite 6	-	-	-	-	6	6	-
Private Suite 7	70	36	40	32	30	70	80
Private Suite 8	100	60	56	54	50	100	120
Private Suite 9	-	-	-	-	12	12	-
Private Suite 10	-	-	-	-	6	6	-
Private Suite 11	-	-	-	-	6	6	-
May Fair Kitchen	-	-	-	-	-	150	-
Private Dining Room	70	-	30	-	20	64	100
May Fair Terrace	-	-	-	-	-	-	50

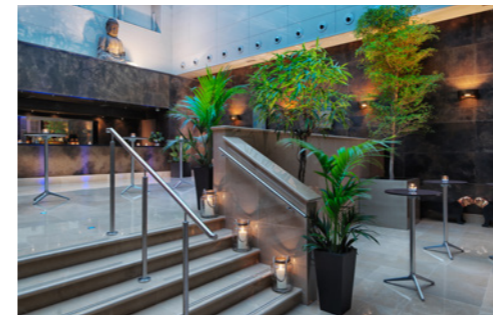

# The May Fair, A Radisson Collection Hotel

May Fair ★★★★★

## Bedrooms

404 air-conditioned bedrooms

- 210 Standard/Superior
- 135 Premium
- 22 Family Rooms
- 37 Suites

## May Fair Spa

Turn valuable time into still more valuable results through a meticulously tailored experience, re-emphasising wellbeing and health.

## Restaurants & Bar

### May Fair Kitchen

As the flagship kitchen, our menu showcases the best of Spanish and Italian small plates while also serving signature dishes from our sister Kitchens.

### May Fair Terrace

Welcome to a hidden, heated open-air terrace that provides an intimate and elegant backdrop to cocktails and small plates, this stunning space is perfect for private events and parties.

### May Fair Bar

Calm by day and lively by night, May Fair Bar is the perfect place to enjoy coffee catchups, leisurely brunches and cocktail evenings. Using fresh ingredients and homemade tinctures, May Fair Bar often hosts pop-ups and collaborations with renowned drink labels.

## Travel

### Car Park

- Grosvenor Hill

### Underground

- Green Park (Piccadilly, Victoria and Jubilee Lines)
- Bond Street (Elizabeth Line)

### Airports

- City Airport (11 miles)
- Heathrow (15 miles)
- Gatwick (28 miles)
- Luton (35 miles)
- Stansted (37 miles)

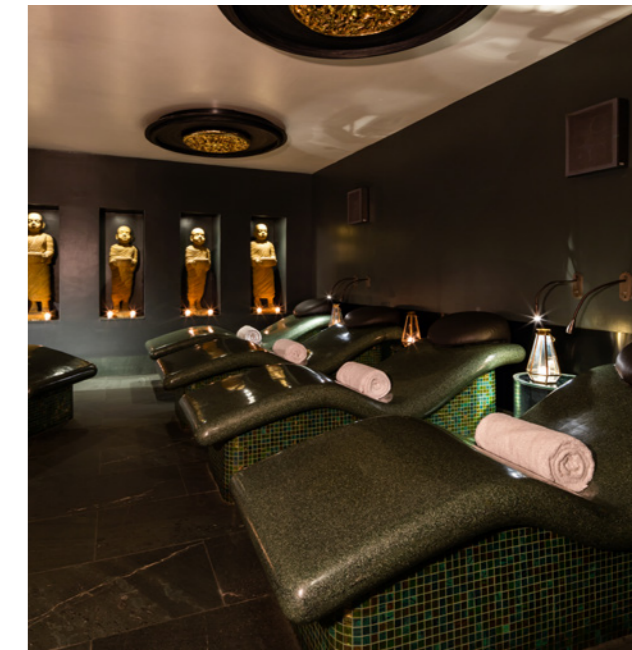



# The Edwardian Manchester, A Radisson Collection Hotel

Manchester ★★★★★

The award-winning five-star Manchester hotel is set inside the historic Free Trade Hall, one of the city's oldest and most iconic buildings, known for its musical and cultural past.

Twenty fully-equipped meeting rooms and a spectacular event room can accommodate as many as 500 guests.

📶 Complimentary Wi-Fi up to 150Mbps on unlimited devices

🗨️ Edward virtual host

🏊 24-hour fully-equipped gym

🏆 Radisson Rewards

THE EDWARDIAN MANCHESTER,  
A RADISSON COLLECTION HOTEL

Peter Street  
Manchester  
M2 5GP

T +44 (0)161 835 8933

E [events.manchester@edwardian.com](mailto:events.manchester@edwardian.com)

📍 St Peter's Square (Metrolink) /  
Manchester Piccadilly



# The Edwardian Manchester, A Radisson Collection Hotel

Manchester ★★★★★



## Capacities

Suites	Theatre	Classroom	Boardroom	U-shape	Cabaret	Reception	Lunch/Dinner
Private Room 1	-	-	10	-	-	-	8
Private Room 2	-	-	10	-	-	-	8
Private Room 3	-	-	10	-	-	-	8
Private Room 4	80	40	24	24	50	80	60
Private Room 5	26	-	16	-	-	-	16
Private Room 6	-	-	16	-	-	-	16
Private Room 7	26	-	16	-	-	-	16
Hallé Suite	400	180	80	90	180	500	280
The First Floor Foyer	-	-	-	-	-	50	-
Private Room 8	120	50	30	30	54	125	80
Private Room 9	60	24	20	-	24	50	30
Private Room 10	60	24	20	-	24	50	30
Private Room 11	120	50	30	30	54	125	80
The Hallé Bar	-	-	-	-	-	180	-
Private Room 12	30	20	18	20	18	35	20
Private Room 13	30	20	18	20	18	35	20
Private Room 14	30	16	16	16	18	35	20
The Third Floor Foyer	-	-	-	-	-	50	-

Suites	Theatre	Classroom	Boardroom	U-shape	Cabaret	Reception	Lunch/Dinner
Private Room 15 & 16	80	40	36	30	40	60	60
Private Room 15	30	16	14	12	12	20	20
Private Room 16	50	30	16	18	18	30	30
Private Room 17	50	20	24	18	18	50	30
Private Room 18	50	20	24	18	18	50	30
Private Room 19 & 20	100	50	40	36	60	80	80
Private Room 19	50	26	20	20	24	40	40
Private Room 20	40	18	14	14	12	20	20
The Fourth Floor Foyer	-	-	-	-	-	60	-

# The Edwardian Manchester, A Radisson Collection Hotel

Manchester ★★★★★

## Bedrooms

263 air-conditioned bedrooms

- 74 Standard/Superior
- 165 Premium
- 24 Suites

## The Spa & Gym

Our tranquil spa is tucked away in the building's vaults, with mindfulness treatments, a 12-metre swimming pool, sauna, steam room and a state-of-the-art gym.

## Restaurant

**Peter Street Kitchen**

Experience award-winning dining in a beautiful setting at Peter Street Kitchen, where contemporary Japanese and Mexican small plates are served alongside a collection of fine wines, cocktails and sakes.

## The Library

Savour one of Manchester's finest afternoon teas at The Library, freshly prepared in-house by The Library's pâtissiers. The Library is also the perfect place to enjoy signature cocktails, à la carte dining and Champagne.

## Travel

**Car Park**

- Great Northern Manchester Central NCP M3 4EE

**Metrolink**

- St Peter's Square

**Trains**

- Manchester Piccadilly (1 mile)
- Manchester Victoria (1 mile)

**Airport**



- Manchester (10 miles)



# Radisson Blu Edwardian, Heathrow Hotel and Conference Centre

Heathrow Airport ★★★★★

The award-winning Heathrow hotel feels anything but an airport hotel. Dramatic spaces, distinctive design and dedicated service come together in a location where London meets the world. Sweeping dimensions are ideal for entertaining and events on a grand scale, whilst a state-of-the-art spa and two buzzing restaurant concepts make this hotel perfect for work or play.

-  Complimentary Wi-Fi up to 150Mbps on unlimited devices
-  Edward virtual host
-  24-hour fully-equipped gym
-  Assessed and Trained by Healthcare Venues
-  Radisson Rewards

## HEATHROW

140 Bath Road  
Hayes  
Middlesex  
UB3 5AW

T +44 (0)20 8757 7903  
E [htrwcb@edwardian.com](mailto:htrwcb@edwardian.com)  
📍 Heathrow



# Radisson Blu Edwardian, Heathrow Hotel and Conference Centre

Heathrow Airport ★★★★★

## Capacities

Suites	Theatre 20	Classroom	Boardroom	U-shape	Cabaret	Reception	Lunch/Dinner
<b>Commonwealth</b>	700	350	-	-	400	700	550
- Commonwealth East	400	130	-	-	180	400	250
- Commonwealth West	300	130	-	-	150	300	250
<b>County</b>	500	230	-	-	230	500	350
- County A	100	50	32	20	50	100	60
- County B	70	40	32	38	40	100	50
- County C	120	72	36	34	80	100	100
- County D	90	65	36	32	50	100	60
<b>Royal</b>	300	100	-	-	120	450	250
- Royal A	50	32	24	20	40	60	50
- Royal B	50	32	24	20	40	60	50
- Royal C	50	32	24	20	40	60	50
- Royal D	50	32	24	20	40	60	50
<b>Newbury</b>	-	-	-	-	-	500	250
<b>Newbury 2</b>	150	80	70	60	120	300	150
<b>Connaught Suite</b>	150	60	42	42	80	150	120
- Connaught A	60	30	25	30	35	60	60
- Connaught B	60	30	25	32	35	60	60
<b>Private Room 11</b>	100	70	40	35	70	125	100
<b>Private Room 12</b>	100	70	40	35	70	125	100
<b>Private Room 15</b>	-	-	4	-	-	-	-
<b>Private Room 17</b>	-	-	6	-	-	-	-

Suites	Theatre 20	Classroom	Boardroom	U-shape	Cabaret	Reception	Lunch/Dinner
<b>Private Room 18</b>	-	-	14	-	-	-	-
<b>Private Room 19</b>	-	-	12	-	-	-	-
<b>Private Room 30</b>	-	-	6	-	-	-	-
<b>Private Room 31</b>	12	10	12	-	-	-	-
<b>Private Room 32</b>	50	25	25	18	24	40	30
<b>Private Room 33</b>	50	25	25	25	24	40	30
<b>Private Room 34</b>	15	10	10	8	-	-	-
<b>Private Room 35</b>	15	10	10	8	-	-	-
<b>Private Room 36</b>	-	-	4	-	-	-	-
<b>Private Room 37</b>	-	-	8	-	-	-	-
<b>Private Room 38</b>	100	50	45	35	70	125	100
<b>Private Room 40</b>	36	26	20	16	16	20	20
<b>Private Room 41</b>	50	30	25	20	25	50	30
<b>Private Room 42</b>	30	18	20	14	20	30	20

# Radisson Blu Edwardian, Heathrow Hotel and Conference Centre

Heathrow Airport ★★★★★

## Bedrooms

464 air-conditioned bedrooms

- 323 Standard/Superior
- 119 Premium
- 5 Family Rooms
- 17 Suites

## The Spa & Gym

Trained therapists are on-hand for a number of revitalising and relaxing treatments, complemented by a hot Jacuzzi, steam room and sauna, day beds and a gym with up-to-date equipment from Technogym.

## Restaurants

**Steak & Lobster**

Celebrating the finest from land and sea, lobsters can be enjoyed in their purest form straight from the charcoal grill, on a baked brioche roll or through other exquisite combination.

**Bijou Lounge Bar**

Combining contemporary décor and comfortable furnishings, Bijou serves delicious classics alongside signature cocktails and wine.

## Travel

**Car Park**

- Hotel car park available

**Underground**

- Heathrow Airport (Piccadilly and Elizabeth Lines)

**Train**

- King's Cross St. Pancras Eurostar (18 miles)

**Airport**

- Terminals 2 & 3 (5 minutes)
- Terminal 4 (8 minutes)
- Terminal 5 (15 minutes)
- Free public transport
- Hotel Hoppa transfer service operates between hotel and all terminals (charges apply)



# Radisson Blu Edwardian, Hampshire

Leicester Square ★★★★★

With sensational views across London's skyline, the Hampshire's Penthouse is an award-winning space designed to make the boldest of statements. There are also five flexible spaces for smaller meetings and events, in an iconic West End location.

📶 Complimentary Wi-Fi up to  
150Mbps on unlimited devices

🗨️ Edward virtual host

🏋️ 24-hour fully-equipped gym

🏆 Radisson Rewards

## HAMPSHIRE

31-36 Leicester Square  
London  
WC2H 7LH

T +44 (0)20 7451 0228

E [hampcb@edwardian.com](mailto:hampcb@edwardian.com)

📍 Leicester Square



# Radisson Blu Edwardian, Hampshire

Leicester Square ★★★★★

Radisson Blu Edwardian, Hampshire boasts five meeting rooms with capacity for up to 24 seated and 45 standing. The Hampshire Penthouse suite has capacity for up to 100 guests.

## Capacities

Suites	Theatre	Classroom	Boardroom	U-shape	Cabaret	Reception	Lunch/Dinner
Penthouse	100	48	28	34	50	100	60
Private Room 1	25	12	15	15	12	25	12
Private Room 2	25	12	15	15	12	25	12
Private Room 3	25	12	15	15	12	25	12
Private Room 4	15	8	8	8	-	15	8
Private Room 5	40	18	24	24	24	45	30

## Bedrooms

127 air-conditioned bedrooms

- 73 Standard/Superior
- 31 Premium
- 9 Family Rooms
- 14 Suites

## Restaurant & Bar

### Leicester Square Kitchen

Discover an exquisite selection of contemporary Mexican and Peruvian small plates, complemented with the finest wines and our signature cocktails.

### At The Hampshire Lounge Bar

By day, it's the perfect retreat for informal lunch meetings or coffee. By night, enjoy our exceptional bar bites with a selection of exquisite cocktails.

## Travel

### Car Park

- Whitcomb Street

### Underground

- Leicester Square (Piccadilly and Northern Lines)
- Piccadilly Circus (Bakerloo and Piccadilly Lines)
- Tottenham Court Road (Elizabeth Line)

### Trains

- Charing Cross (7 mins walk)
- Waterloo (1 mile)
- King's Cross St. Pancras Eurostar (2 miles)

## Airport

- City Airport (10 miles)
- Heathrow (18 miles)
- Gatwick (28 miles)
- Luton (35 miles)
- Stansted (37 miles)





# Radisson Blu Edwardian, Mercer Street

Covent Garden ★★★★★ (deluxe)

Welcome to a well-appointed boutique venue in Covent Garden's Seven Dials village. Four HD-ready meeting rooms can host up to 60 guests theatre style.

📶 Complimentary Wi-Fi up to 150Mbps on unlimited devices

🗺️ Edward virtual host

🏋️ 24-hour fully-equipped gym

🏆 Radisson Rewards

## MERCER STREET

20 Mercer Street  
Covent Garden  
London  
WC2H 9HD

T +44 (0)20 7845 8613  
E [merc.cb@edwardian.com](mailto:merc.cb@edwardian.com)  
📍 Covent Garden



# Radisson Blu Edwardian, Mercer Street

Covent Garden ★★★★★ (deluxe)

## Capacities

Suites	Theatre	Classroom	Boardroom	U-shape	Cabaret	Reception	Lunch/Dinner
Private Room 3	-	-	6	-	-	-	-
Private Room 4	30	12	16	14	12	30	16
Private Room 5	-	-	8	-	-	-	-
Private Room 6	60	27	18	27	32	60	40

## Bedrooms

137 air-conditioned bedrooms

- 73 Standard/Superior
- 40 Premium
- 10 Family Rooms
- 14 Suites

## Restaurant

### Monmouth Kitchen

A natural meeting hub and destination in its own right, Monmouth Kitchen showcases a contemporary selection of Italian and Peruvian small plates complemented by fine wines and signature cocktails.

## Travel

### Car Park

- Museum Street
- Shelton Street

### Underground

- Covent Garden (Piccadilly Line)
- Leicester Square (Piccadilly and Northern Lines)
- Tottenham Court Road (Central, Northern and Elizabeth Lines)

## Trains

- Charing Cross (0.8 mile)
- Waterloo (1 mile)
- King's Cross St. Pancras Eurostar (2 miles)

## Airport

- City Airport (10 miles)
- Heathrow (18 miles)
- Gatwick (28 miles)
- Luton (35 miles)
- Stansted (37 miles)



# Radisson Blu Edwardian, Bloomsbury Street

Bloomsbury ★★★★★ (deluxe)

Refurbished to the highest specification, the meeting and event spaces have been designed with beaded panelling, monochrome art photography, and adjustable lighting to recreate the residential feeling of a modern London townhouse.

The hotel's largest and most impressive room is the Folio Suite, featuring capacities of up to 300 guests. Stunning bay windows let in natural light, whilst an adjoining living room and breakout area with a private bar make for the perfect space to host.

📶 Complimentary Wi-Fi up to 150Mbps on unlimited devices

🗨️ Edward virtual host

🏋️ 24-hour fully-equipped gym

🏥 Assessed and Trained by Healthcare Venues

🏆 Radisson Rewards

## BLOOMSBURY STREET

9-13 Bloomsbury Street  
London  
WC1B 3QD

T +44 (0)20 7666 2322

E [bshcb@edwardian.com](mailto:bshcb@edwardian.com)

📍 Tottenham Court Road



# Radisson Blu Edwardian, Bloomsbury Street

Bloomsbury ★★★★★ (deluxe)

## Capacities

Suites	Theatre	Classroom	Boardroom	U-shape	Cabaret	Reception	Lunch/ Dinner	Dinner Dance
Folio Room	230	120	50	60	120	350	220	200
- Folio Room 1 & 2	150	90	50	40	75	240	150	140
- Folio Room 2 & 3	140	60	36	35	60	150	100	120
- Folio Room 1	120	52	28	30	42	150	100	80
- Folio Room 2	60	32	24	24	24	75	50	-
- Folio Room 3	50	24	22	18	24	70	40	-
Private Room 1	34	16	15	16	16	35	20	-
Private Room 2	60	28	30	32	48	60	50	40
Private Room 3	28	16	15	16	16	30	20	-
The Library	30	12	12	16	16	30	20	-

## Bedrooms

175 air-conditioned bedrooms

- 77 Standard/Superior
- 81 Premium
- 10 Family Rooms
- 7 Suites

## Restaurant

**Bloomsbury Street Kitchen**

Decorated with greenery and natural materials, Bloomsbury Street Kitchen serves cocktails and an exquisite selection of contemporary Mediterranean and Japanese small plates.

## Travel

**Car Park**

- Great Russell Street

**Underground**

- Tottenham Court Road (Central, Northern and Elizabeth Lines)

**Trains**

- Euston (1 mile)
- King's Cross St. Pancras Eurostar (1.7 miles)

**Airport**

- City Airport (9 miles)
- Heathrow (18 miles)
- Gatwick (28 miles)
- Luton (35 miles)
- Stansted (37 miles)



# Radisson Blu Edwardian, Grafton

Fitzrovia ★★★★★

Welcome to our historic 19th century hotel in charming Fitzrovia, moments from Euston, King's Cross and the West End.

Perfect for guests travelling from near and far, Grafton is one of our best-connected hotels, featuring event spaces for up to 150 guests.

📶 Complimentary Wi-Fi up to 150Mbps on unlimited devices

🗨️ Edward virtual host

🏋️ 24-hour fully-equipped gym

🏥 Assessed and Trained by Healthcare Venues

🏆 Radisson Rewards

## GRAFTON

130 Tottenham Court Road  
London  
W1T 5AY

T +44 (0)20 7666 5477  
E [graftcb@edwardian.com](mailto:graftcb@edwardian.com)  
📍 Warren Street



# Radisson Blu Edwardian, Grafton

Fitzrovia ★★★★★

## Capacities

Suites	Theatre	Classroom	Boardroom	U-shape	Cabaret	Reception	Lunch/Dinner
Warren	110	50	30	30	64	150	100
Grafton	70	40	30	30	42	125	80
Southampton	70	40	30	30	42	125	80
Bedford	65	30	20	20	35	80	40
Harlington	60	24	24	25	24	30	40
Beaumont	30	18	16	16	20	50	30
Fitzroy	30	18	16	16	20	50	30
Tavistock	-	-	10	-	-	-	-
Cleveland	-	-	10	-	-	-	-
Clarence	-	-	8	-	-	-	-
Langham	-	-	12	-	-	-	-

## Bedrooms

330 air-conditioned bedrooms

- 73 Individual
- 168 Standard/Superior
- 74 Premium
- 5 Family Rooms
- 10 Suites

## Restaurant

### Steak & Lobster

Celebrating the finest from land and sea, our signature cuts and lobsters can be enjoyed in their purest form straight from the charcoal grill, on a baked brioche roll or through other exquisite combinations.

## Travel

### Car Park

- Euston Station

### Underground

- Warren Street (Victoria and Northern Lines)
- Euston Square (Circle, Hammersmith and Metropolitan Lines)
- Tottenham Court Road (Elizabeth, Central and Northern Lines)

### Trains

- Euston (4 mins walk)
- King's Cross St. Pancras Eurostar (20 mins walk)

## Airport

- City Airport (10 miles)
- Heathrow (18 miles)
- Gatwick (28 miles)
- Luton (35 miles)
- Stansted (37 miles)



# Radisson Blu Edwardian, Kenilworth

Bloomsbury ★★★★★

Radisson Blu Edwardian, Kenilworth is a contemporary townhouse hotel just 50 metres from British Museum and close to Covent Garden. The Bloomsbury Street Hotel is conveniently located next door, offering further meeting room space and accommodation if required.

📶 Complimentary Wi-Fi up to 150Mbps on unlimited devices

🗨️ Edward virtual host

🏋️ 24-hour fully-equipped gym

🏥 Assessed and Trained by Healthcare Venues

🏆 Radisson Rewards

## KENILWORTH

97 Great Russell Street  
London  
WC1B 3BL

T +44 (0)20 7666 2322  
E [kenilcb@edwardian.com](mailto:kenilcb@edwardian.com)  
📍 Tottenham Court Road



# Radisson Blu Edwardian, Kenilworth

Bloomsbury ★★★★★

## Capacities

Suites	Theatre	Classroom	Boardroom	U-shape	Cabaret	Reception	Lunch/Dinner
Private Room 7	24	15	14	15	14	30	16
Private Room 8	-	-	6	-	-	-	8
Private Room 9 & 10	80	36	30	30	42	110	70
Private Room 9	25	15	12	12	15	30	30
Private Room 10	50	20	16	20	24	60	50
Private Room 11 & 12	100	50	34	30	54	120	80
Private Room 11	25	18	12	14	15	30	30
Private Room 12	50	24	20	20	24	80	50
Private Room 14	25	12	12	12	12	25	20
Private Room 15	25	12	14	14	-	25	20

## Bedrooms

186 air-conditioned bedrooms

- 28 Individual
- 104 Standard/Superior
- 40 Premium
- 10 Family Rooms
- 4 Suites

## Restaurant

Scoff & Banter

Stately windows, objets d'art and curved fabric sofas create a contemporary atmosphere in Scoff & Banter, showcasing a menu that celebrates modern European cuisine.

## Travel

Car Park

- Great Russell Street

Underground

- Tottenham Court Road (Central, Northern and Elizabeth Lines)

Trains

- Euston (1 mile)
- King's Cross St. Pancras Eurostar (1.7 miles)

Airport

- City Airport (9 miles)
- Heathrow (18 miles)
- Gatwick (28 miles)
- Luton (35 miles)
- Stansted (37 miles)





# Radisson Blu Edwardian, Vanderbilt

South Kensington ★★★★★

Radisson Blu Edwardian, Vanderbilt has a prime location in leafy Kensington, with nearby links to Heathrow and Knightsbridge on its doorstep. The hotel's extensive meeting facilities are complemented by a warm, classic English ambience with restored features including richly decorated frescoes, stained glass windows and wood-panelled rooms.

📶 Complimentary Wi-Fi up to 150Mbps on unlimited devices

🗨️ Edward virtual host

🏋️ 24-hour fully-equipped gym

🏥 Assessed and Trained by Healthcare Venues

🏆 Radisson Rewards

## VANDERBILT

68-86 Cromwell Road  
London  
SW7 5BT

T +44 (0)20 7761 9013  
E vandcb@edwardian.com  
📍 Gloucester Road



# Radisson Blu Edwardian, Vanderbilt

South Kensington ★★★★★

## Capacities

Suites	Theatre	Classroom	Boardroom	U-shape	Cabaret	Reception	Lunch/Dinner
Victoria & Albert	100	50	34	34	64	120	90
Cromwell	50	30	26	26	26	50	30
Edwardian	44	30	20	20	24	60	40
Vanderbilt	-	-	12	-	-	-	12
Private Room 1	-	-	10	-	-	-	12
Private Room 2	-	-	10	-	-	-	12
Private Room 3	-	-	12	-	-	-	12
Private Room 4	28	18	18	18	14	30	20
Private Room 5	30	18	18	18	14	30	20
Private Room 6	28	18	18	18	14	30	20
Private Room 7	-	-	8	-	-	-	-
Private Room 8	-	-	8	-	-	-	-

## Bedrooms

215 air-conditioned bedrooms

- 61 Individual
- 88 Standard/Superior
- 47 Premium
- 18 Family Rooms
- 1 Suite

## Restaurant

**Scoff & Banter**

Flooded with natural light, Scoff & Banter is set in an atmospheric space characterised by high ceilings and aesthetic details recalling a bygone era, with a menu that celebrates quintessential British heritage but with modern touches and twists.

## Travel

**Car Park**

- Gloucester Road (6 mins walk)

**Underground**

- Gloucester Road (Piccadilly, Circle and District Lines)

## Travel

**Trains**

- Paddington (1.3 miles)
- Victoria (1.8 miles)
- King's Cross St. Pancras Eurostar (5 miles)

**Airport**

- City Airport (11 miles)
- Heathrow (13 miles)
- Gatwick (32 miles)
- Luton (35 miles)
- Stansted (40 miles)



# Radisson Blu Edwardian, Sussex

Marble Arch ★★★★★

Perfect for small meetings or chic private lunches, the Sussex hotel is a calming boutique retreat tucked away in a quiet corner yet moments from Oxford Street. Sleek, contemporary design compliments a striking modern art collection.

📶 Complimentary Wi-Fi up to 150Mbps on unlimited devices

👤 Edward virtual host

🏋️ 24-hour fully-equipped gym

🏆 Radisson Rewards

SUSSEX

19-25 Granville Place  
London  
W1H 6PA

T +44 (0)20 7845 8680

E londonmeetings@edwardian.com

📍 Marble Arch



# Radisson Blu Edwardian, Sussex

Marble Arch ★★★★★

## Capacities

Suites	Theatre	Classroom	Boardroom	Cabaret	Lunch/Dinner
The Red Room	-	-	4	-	4
The Green Room	-	-	10	-	10

## Bedrooms

### 101 air-conditioned bedrooms

- 31 Individual
- 38 Standard/Superior
- 24 Premium
- 4 Family Rooms
- 4 Suites

## Restaurant

### Steak & Lobster

Celebrating the finest from land and sea, our signature cuts and lobsters can be enjoyed in their purest form straight from the charcoal grill, on a baked brioche roll or through other exquisite combinations.

## Travel

### Car Park

- Bryanston Street

### Underground

- Marble Arch (Central Line)
- Bond Street (Jubilee, Central and Elizabeth Lines)

### Trains

- Marylebone (0.8 mile)
- Victoria (2 miles)
- King's Cross St. Pancras Eurostar (2.5 miles)

### Airport

- City Airport (9 miles)
- Heathrow (18 miles)
- Gatwick (28 miles)
- Luton (35 miles)
- Stansted (37 miles)



# Radisson Blu Edwardian, New Providence Wharf

Canary Wharf ★★★★★ (deluxe)

Welcome to a riverside retreat in London, moments from the city centre, Canary Wharf and London City Airport.

Set on a tranquil bend of the River Thames, discover spacious rooms, waterfront function spaces and a soothing spa with gym. A beautiful place to stay, meet and enjoy unforgettable events.

\*All rooms divide

📶 Complimentary Wi-Fi up to 150Mbps on unlimited devices

🗣️ Edward virtual host

🏋️ 24-hour fully-equipped gym

🏥 Assessed and Trained by Healthcare Venues

🏆 Radisson Rewards

## NEW PROVIDENCE WHARF

5 Fairmont Avenue  
Canary Wharf  
London  
E14 9PQ

T +44 (0)20 7987 6566

E [npwcb@edwardian.com](mailto:npwcb@edwardian.com)

📍 Canary Wharf / East India (DLR)



# Radisson Blu Edwardian, New Providence Wharf

Canary Wharf ★★★★★ (deluxe)

## Capacities

Suites	Theatre	Classroom	Boardroom	U-shape	Cabaret	Reception	Lunch/Dinner
Ontario Room	250	130	60	50	120	250	180
- Ontario Room A	120	70	30	36	60	125	70
- Ontario Room B	100	70	40	36	60	125	70
River Room	70	25	22	15	24	70	50
Private Room 1	50	18	18	14	15	30	30
Private Room 2	50	18	18	12	15	30	20
Private Room 1 & 2	100	36	26	27	40	100	60
Private Room 3	-	-	13	-	-	-	15
Private Room 4	-	-	8	-	-	-	12
Private Room 5	30	-	15	15	-	-	20

## Bedrooms

169 air-conditioned bedrooms

- 82 Standard/Superior
- 70 Premium
- 17 Suites

## Restaurant

### Scoff & Banter

Floor-to-ceiling windows stretch the length of this riverside restaurant, creating a feeling of space and airiness paired with a menu celebrating modern European cuisine.

## Travel

### Car Park

- On-site valet parking is available

### Underground

- Canary Wharf/Canning Town (Jubilee and Elizabeth Lines)
- East India or Blackwall (DLR)

### Train

- King's Cross St. Pancras Eurostar (7 miles)

### Airport

- City Airport (3.4 miles)
- Heathrow (22 miles)
- Gatwick (33 miles)
- Stansted (35 miles)
- Luton (40 miles)

## Shuttle Service

- Complimentary shuttle to Canary Wharf operates: Monday to Friday 6:45am - 9:30am
- There is an additional Friday service between 4:30pm - 6:30pm
- Saturday to Sunday 10am - 12pm and 4:30pm - 6:30pm
- A return service operates from Canary Wharf back to the hotel Monday to Friday.



# Edwardian Hotels London Directory

## The Londoner Leicester Square

38 Leicester Square  
London WC2H 7DX  
T +44(0)20 7451 0101  
E [events@thelondoner.com](mailto:events@thelondoner.com)  
W [thelondoner](http://thelondoner.com)

## The May Fair, A Radisson Collection Hotel

Stratton Street  
London W1J 8LT  
T +44 (0)20 7915 3898  
E [events@themayfairhotel.co.uk](mailto:events@themayfairhotel.co.uk)  
W [themayfairhotel.co.uk](http://themayfairhotel.co.uk)

## The Edwardian Manchester, A Radisson Collection Hotel

Free Trade Hall, Peter Street  
Manchester M2 5GP  
T +44 (0)161 835 8933  
E [events.manchester@edwardian.com](mailto:events.manchester@edwardian.com)  
W [theedwardianmanchester.com](http://theedwardianmanchester.com)

## Radisson Blu Edwardian, Hampshire

31-36 Leicester Square  
London WC2H 7LH  
T +44 (0)20 7451 0228  
E [hampcb@edwardian.com](mailto:hampcb@edwardian.com)  
W [radissonblu-edwardian.com/hampshire](http://radissonblu-edwardian.com/hampshire)

## Radisson Blu Edwardian, Bloomsbury Street

9-13 Bloomsbury Street  
London WC1B 3QD  
T +44 (0)20 7666 2322  
E [bshcb@edwardian.com](mailto:bshcb@edwardian.com)  
W [radissonblu-edwardian.com/bloomsburystreet](http://radissonblu-edwardian.com/bloomsburystreet)

## Radisson Blu Edwardian, Mercer Street

20 Mercer Street  
Covent Garden  
London WC2H 9H  
T +44 (0)20 7845 8613  
E [mercpcb@edwardian.com](mailto:mercpcb@edwardian.com)  
W [radissonblu-edwardian.com/mercerstreet](http://radissonblu-edwardian.com/mercerstreet)

## Radisson Blu Edwardian, Bond Street\*

350 Oxford Street  
London W1C 1BY  
T +44 (0)20 7629 7474  
E [londonmeetings@edwardian.com](mailto:londonmeetings@edwardian.com)  
W [radissonblu-edwardian.com/bondstreet](http://radissonblu-edwardian.com/bondstreet)

\*Bond Street Hotel has private dining spaces, but no meeting rooms.

## Radisson Blu Edwardian, Kenilworth

97 Great Russell Street  
London WC1B 3BL  
T +44 (0)20 7666 2322  
E [kenilcb@edwardian.com](mailto:kenilcb@edwardian.com)  
W [radissonblu-edwardian.com/kenilworth](http://radissonblu-edwardian.com/kenilworth)

## Radisson Blu Edwardian, Grafton

130 Tottenham Court Road  
London W1T 5AY  
T +44 (0)20 7666 5477  
E [graftcb@edwardian.com](mailto:graftcb@edwardian.com)  
W [radissonblu-edwardian.com/grafton](http://radissonblu-edwardian.com/grafton)

## Radisson Blu Edwardian, Vanderbilt

68-86 Cromwell Road  
London SW7 5BT  
T +44 (0)20 7761 9013  
E [vandcb@edwardian.com](mailto:vandcb@edwardian.com)  
W [radissonblu-edwardian.com/vanderbilt](http://radissonblu-edwardian.com/vanderbilt)

## Radisson Blu Edwardian, Sussex

19-25 Granville Place  
London W1H 6PA  
T +44 (0)20 7845 8680  
E [londonmeetings@edwardian.com](mailto:londonmeetings@edwardian.com)  
W [radissonblu-edwardian.com/sussex](http://radissonblu-edwardian.com/sussex)

## Radisson Blu Edwardian, New Providence Wharf

5 Fairmont Avenue, Canary Wharf  
London E14 9PQ  
T +44 (0)20 7987 6566  
E [npwcb@edwardian.com](mailto:npwcb@edwardian.com)  
W [radissonblu-edwardian.com/newprovidencewharf](http://radissonblu-edwardian.com/newprovidencewharf)

## Radisson Blu Edwardian, Heathrow

140 Bath Road, Hayes  
Middlesex UB3 5AW  
T +44 (0)20 8757 7903  
E [htrwcb@edwardian.com](mailto:htrwcb@edwardian.com)  
W [radissonblu-edwardian.com/heathrow](http://radissonblu-edwardian.com/heathrow)



# London Locations Map

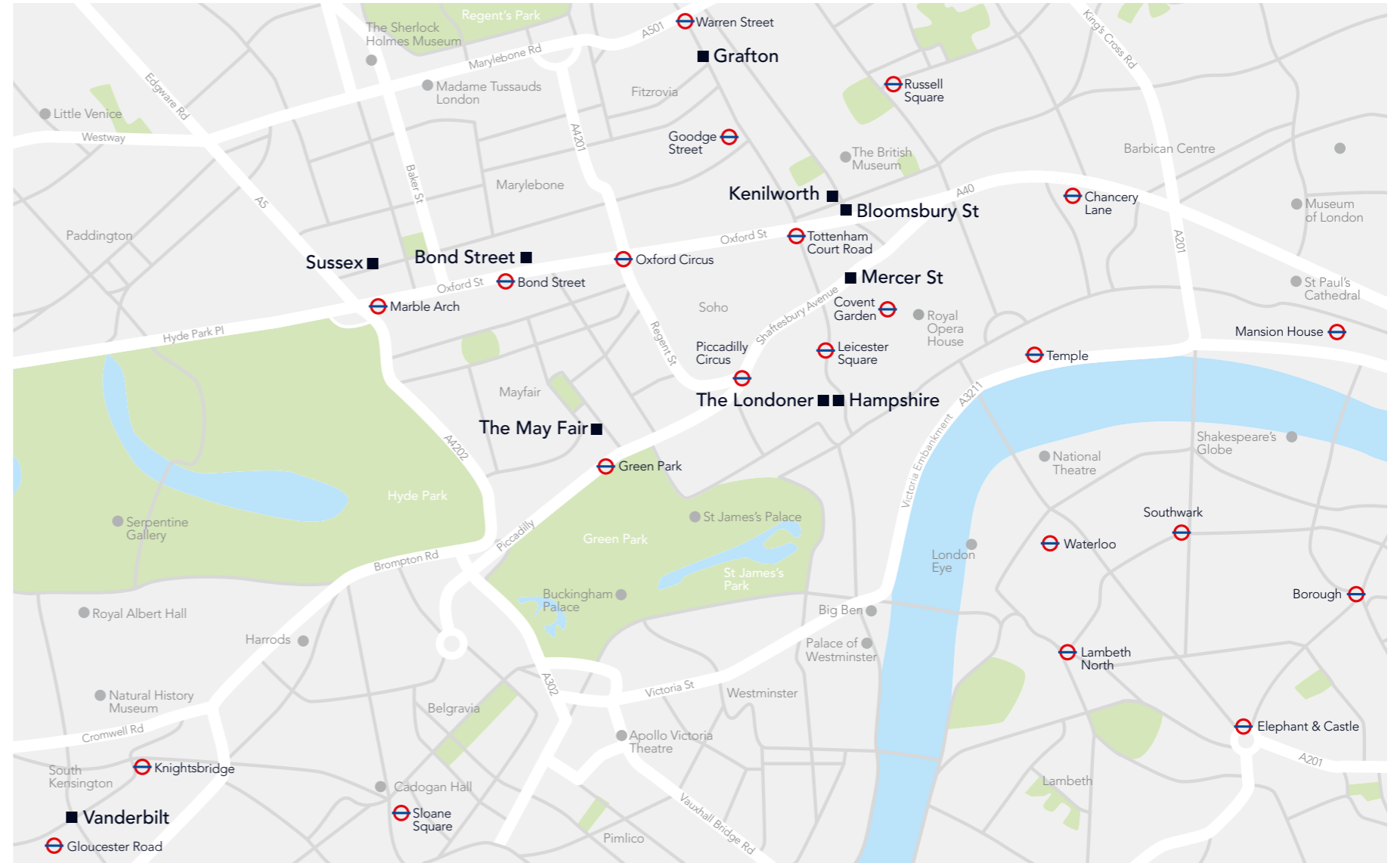
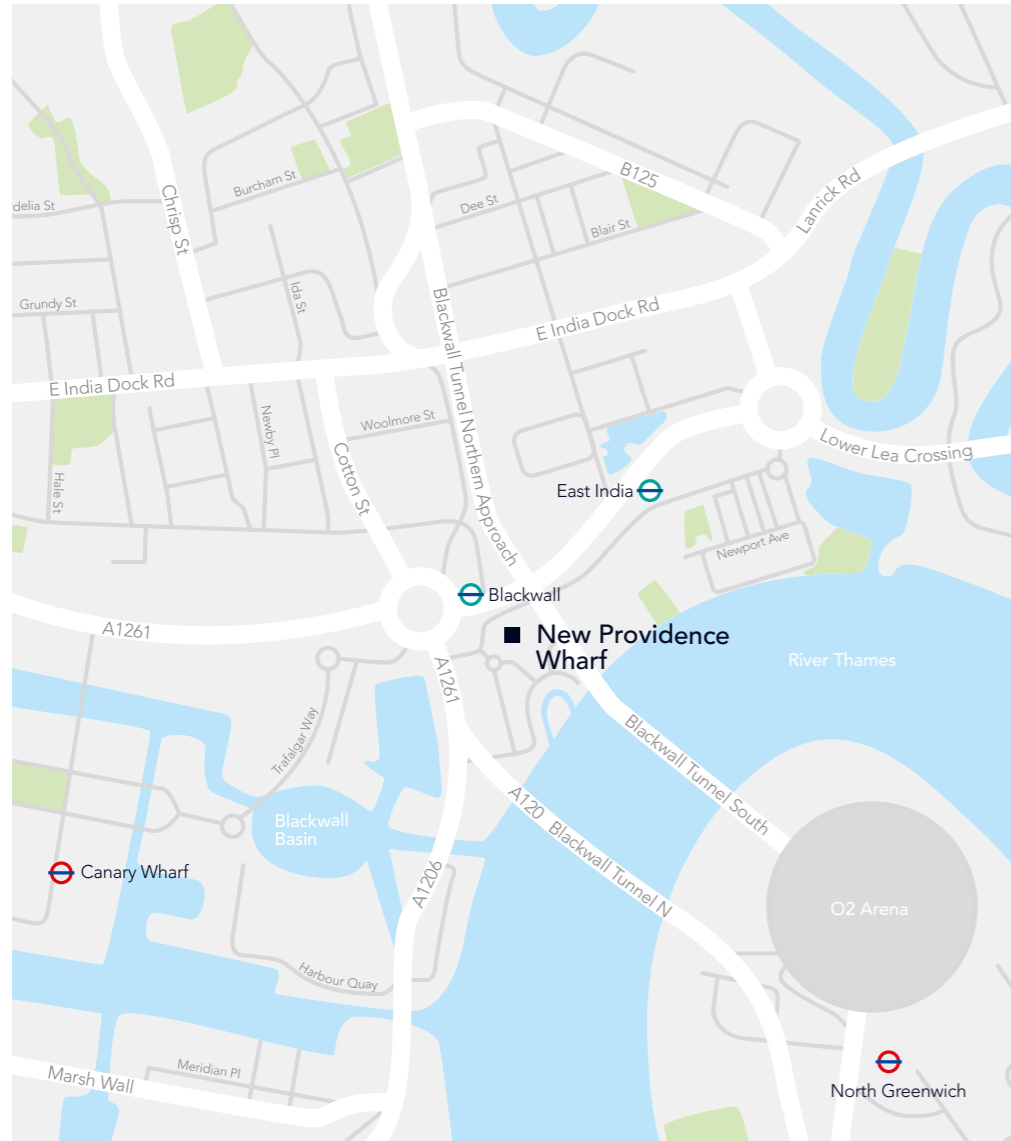



# Heathrow Map

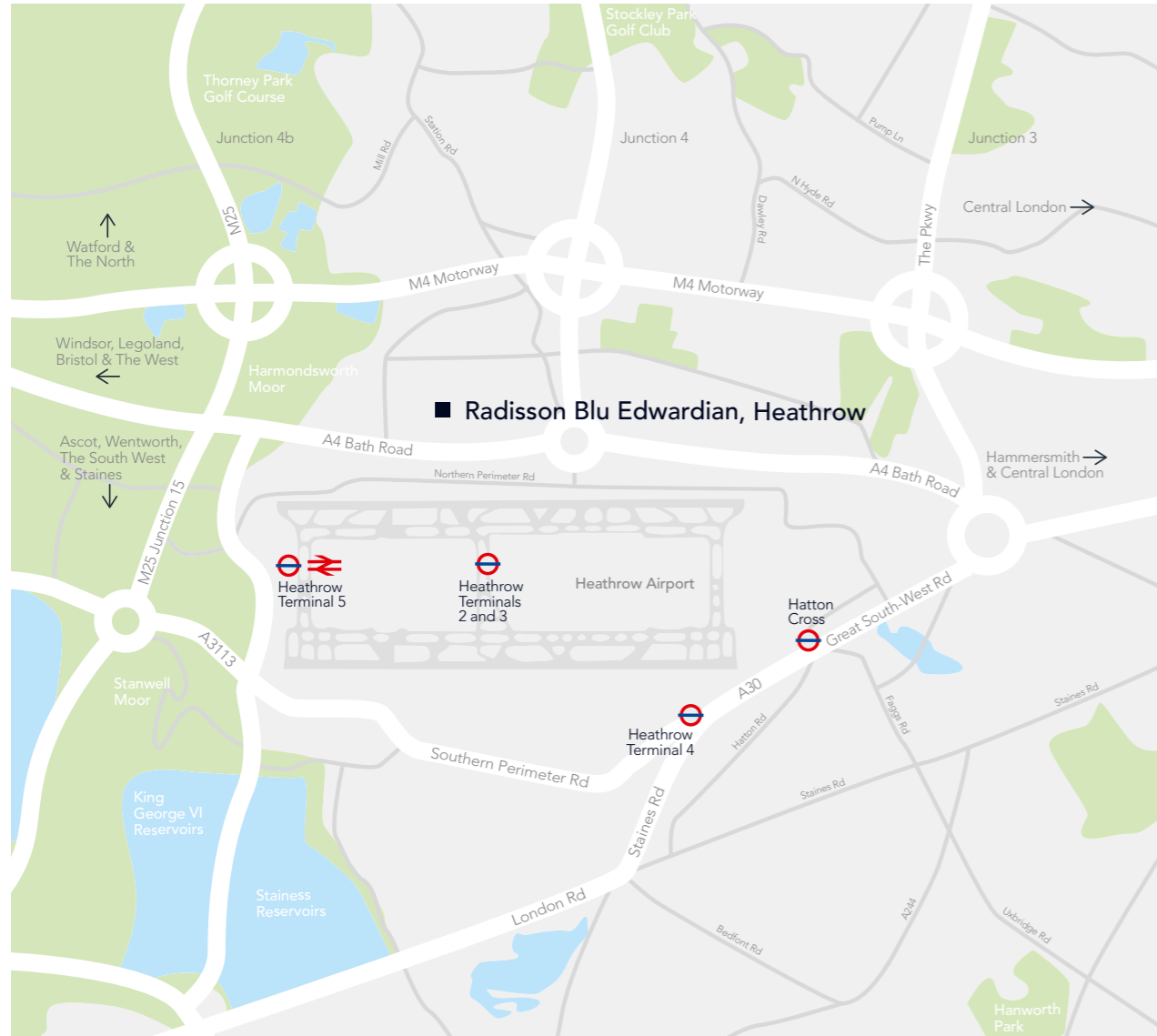

# Manchester Map

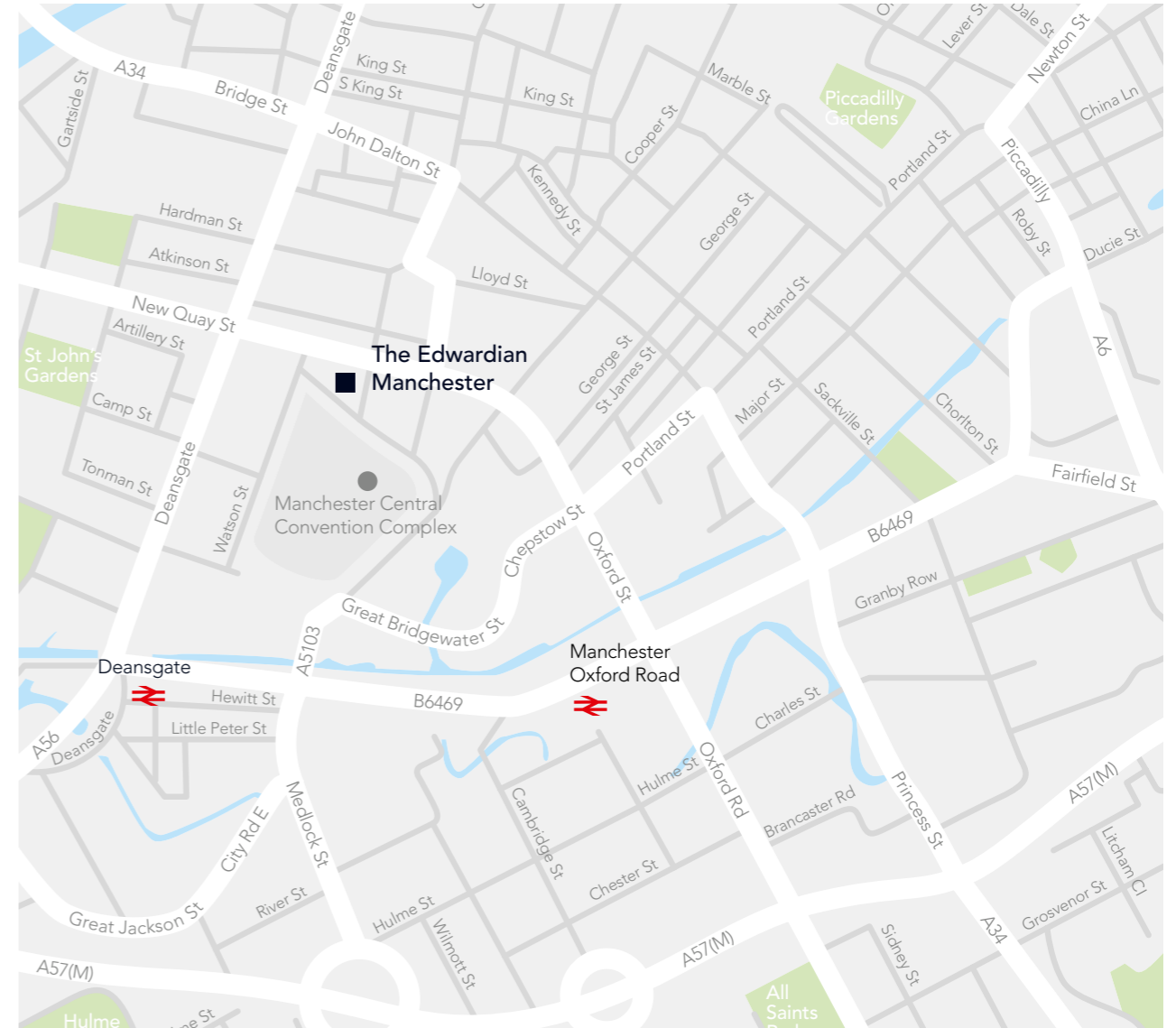



EDWARDIAN  
HOTELS  
LONDON

## Contact us

### London

T +44 (0)20 7845 8680

E [londonmeetings@edwardian.com](mailto:londonmeetings@edwardian.com)

### Heathrow

T +44 (0)20 8757 7903

E [htrwcb@edwardian.com](mailto:htrwcb@edwardian.com)

### Manchester

T +44 (0)161 835 8933

E [events.manchester@edwardian.com](mailto:events.manchester@edwardian.com)